



February 28, 2025

PUBLIC NOTICE 11-163a

All interested parties are herein notified that the Commander, Eleventh Coast Guard District, has received application materials dated February 7, 2025 from the California Department of Transportation (Caltrans) for approval of location and plans for the modification of a highway bridge across a navigable waterway of the United States.

BRIDGE, WATERWAY AND LOCATION: Petaluma River (State Route 37) bridge across the Petaluma River, mile 1.0, on State Route 37, at the Marin/Sonoma County line, California. (38.11581, -122.50534)

CHARACTER OF WORK: The existing timber bridge fender system would be removed and replaced. The proposed fender system would be comprised of approximately 96 piles. The replaced fender system would consist of 24-in steel pipe piles and steel walers with plastic lumber sheathing. Navigation lighting would be upgraded to meet the U.S. Coast Guard requirements. The existing piles would be removed down to three feet below the mudline. The existing, to be removed piles, are located behind the replacement fender system, out of the main navigation span. The proposed replacement pier protection system will reduce the horizontal clearance of the bridge by 12 feet.

MINIMUM NAVIGATIONAL CLEARANCES:

| | Existing | Proposed |
|-------------------|--|--|
| Vertical | 71.32 feet above Mean High Water (MHW) | 71.32 feet above MHW |
| Horizontal | 140 feet, measured fender to fender, normal to the axis of the channel | 128 feet, measured fender to fender, normal to the axis of the channel |

Datum: MHW elevation of 5.45 feet, NAVD88

ENVIRONMENTAL CONSIDERATIONS:

Under the provisions of 23 U.S.C. 327, the United States Department of Transportation Secretary, acting through the Federal Highway Administration, assigned the responsibilities for the National Environmental Policy Act (NEPA) and other federal environmental laws to Caltrans. Caltrans is the lead Federal agency for satisfying the requirements of NEPA. Caltrans is acting on behalf of the U.S. Coast Guard (USCG) for all environmental control laws. Caltrans has determined that the proposed action will not have a significant impact on the environment. A Caltrans Categorical Exclusion (CE) was issued on December 30, 2022, pursuant to NEPA, as amended. The U.S. Coast Guard has tentatively determined that the proposed action will not have a significant impact for the purposes of NEPA and intends to issue a CE for the project.

A water quality certification in accordance with Section 401 of the Clean Water Act, as amended, for this project was applied for from the San Francisco Bay Regional Water Quality Control Board on October 3, 2024. This project will impact no wetlands.

The bridge is located in the floodplain. The 100-year flood elevation is 9.55 feet. The elevation of the low member of the navigation span is 76.77. Elevations are referenced to NAVD 88 datum. Approximately zero cubic yards of fill material will be placed below MHW level for the bridge modification project.

SOLICITATION OF COMMENTS:

Mariners are requested to comment on the proposed navigation clearances, placement of a bridge protective system and other navigational safety issues, including need for clearance gauges and extent of nighttime navigation to determine the need for bridge lighting. Interested parties are requested to express their views, in writing, on the proposed bridge project including its possible impacts to navigation.

We will forward comments of an environmental nature such as those regarding wildlife refuges, public parks, historic sites, wetlands, floodplain issues, air, water quality, environmental justice, etc. to Caltrans. Comments will be received for the record at the address noted in the header or via email at D11Bridges@uscg.mil through March 31, 2025.

Map of location and plans attached.

Sincerely,

CARL T. HAUSNER
Chief, Bridge Section
Eleventh Coast Guard District
By direction of the District Commander

Postmaster: Please Post

**STATE OF CALIFORNIA
DEPARTMENT OF TRANSPORTATION**

**PROJECT PLANS FOR CONSTRUCTION ON
STATE HIGHWAY**

**IN MARIN COUNTY
NEAR NOVATO
AT PETALUMA RIVER BRIDGE**

| Dist | COUNTY | ROUTE | POST MILES TOTAL PROJECT | SHEET No. | TOTAL SHEETS |
|------|--------|-------|-----------------------------|--------------|-----------------|
| 04 | Mrn | 37 | 14.5 | 1 | |

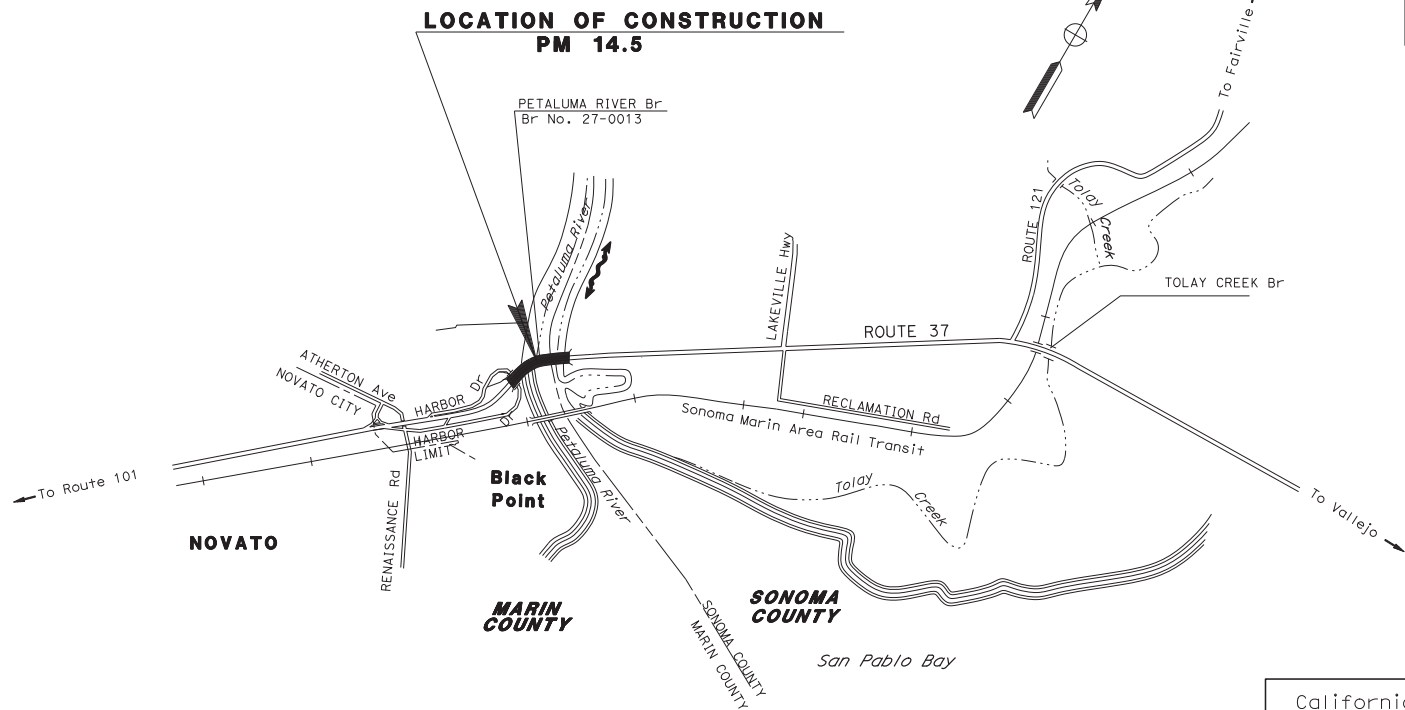

Jason Phoen 2-18-25
PROJECT ENGINEER DATE
REGISTERED CIVIL ENGINEER



CONCEPTUAL PLAN UTILIZED TO OBTAIN COAST GUARD PERMIT

California Department of Transportation
Fender Replacement
Petaluma River (State Route 37) Bridge
Petaluma River, Mile 1.0
At the Sonoma/Marin County line, California
February 18, 2025 Sheet 1 of 4

DATUM: NAVD 88



CALTRANS WEB SITE IS: [HTTP://WWW.DOT.CA.GOV/](http://www.dot.ca.gov/)

RELATIVE BORDER SCALE IS IN INCHES 0 1 2 3

DATE PLOTTED => 14-FEB-2025
TIME PLOTTED => 16:41

0.0 CUBIC YARD OF FILL BELOW MHW

| DIST | COUNTY | ROUTE | POST MILES TOTAL PROJECT | SHEET No. | TOTAL SHEETS |
|------|--------|-------|--------------------------|-----------|--------------|
| 04 | Mrn | 37 | 14.5 | | |

| | | |
|---|--|-----------------|
| <i>Jason Phoen</i> REGISTERED CIVIL ENGINEER | | 2-18-25 DATE |
| THE STATE OF CALIFORNIA OR ITS OFFICERS OR AGENTS SHALL NOT BE RESPONSIBLE FOR THE ACCURACY OR COMPLETENESS OF SCANNED COPIES OF THIS PLAN SHEET. | | |

LEGEND:
--- Existing Structure

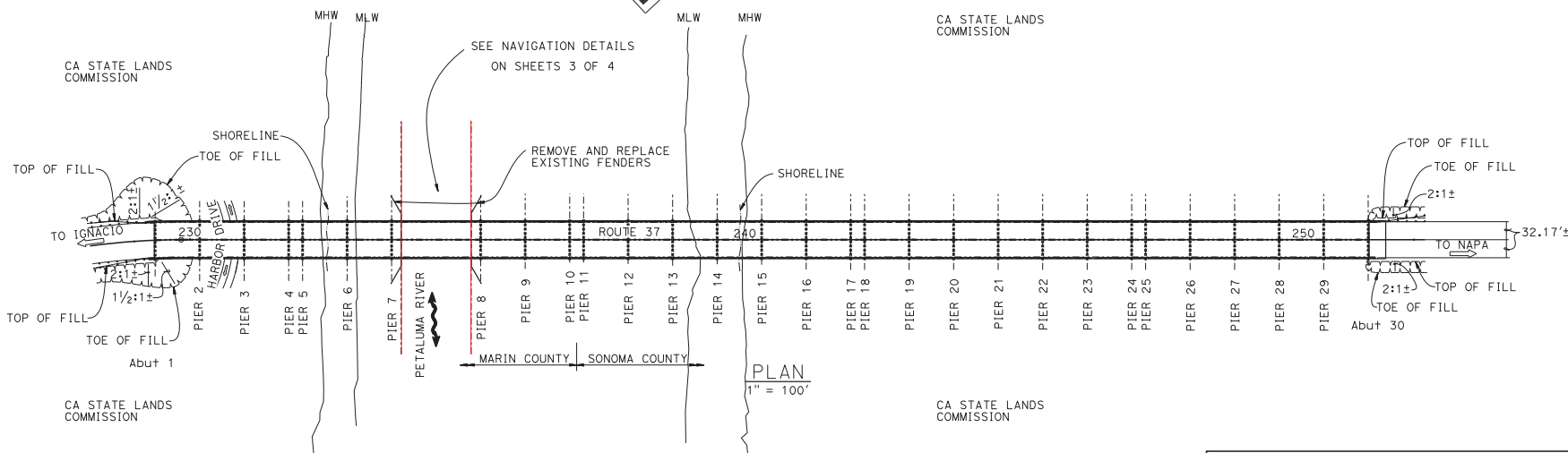
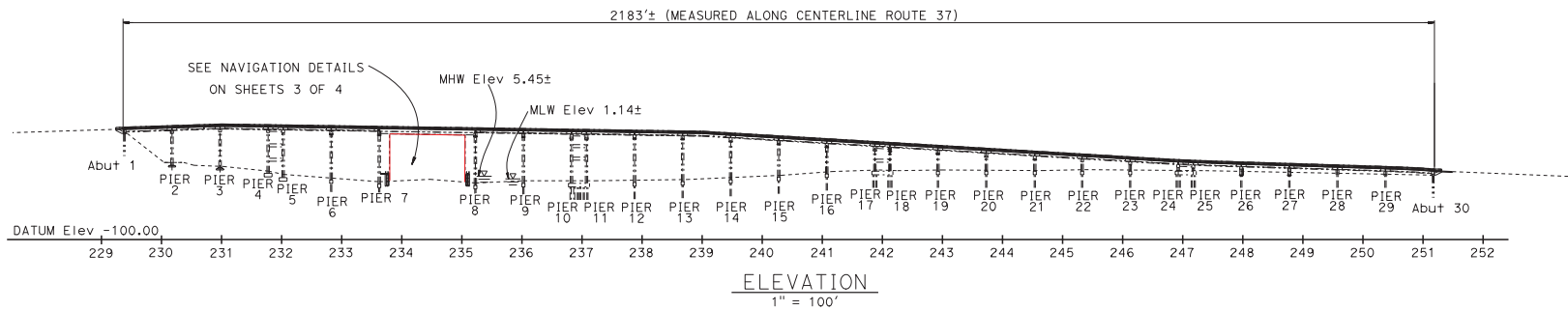

CONCEPTUAL PLAN UTILIZED TO OBTAIN COAST GUARD PERMIT

California Department of Transportation
 Fender Replacement
 Petaluma River (State Route 37) Bridge
 Petaluma River, Mile 1.0
 At the Sonoma/Marin County line, California
 February 18, 2025



STATE OF CALIFORNIA - DEPARTMENT OF TRANSPORTATION
 FUNCTIONAL SUPERVISOR
 CALCULATED BY
 DESIGNED BY
 CHECKED BY
 REVISED BY
 DATE REVISED

LAST REVISION DATE PLOTTED => 14-FEB-2025
 02-18-25 TIME PLOTTED => 17:11

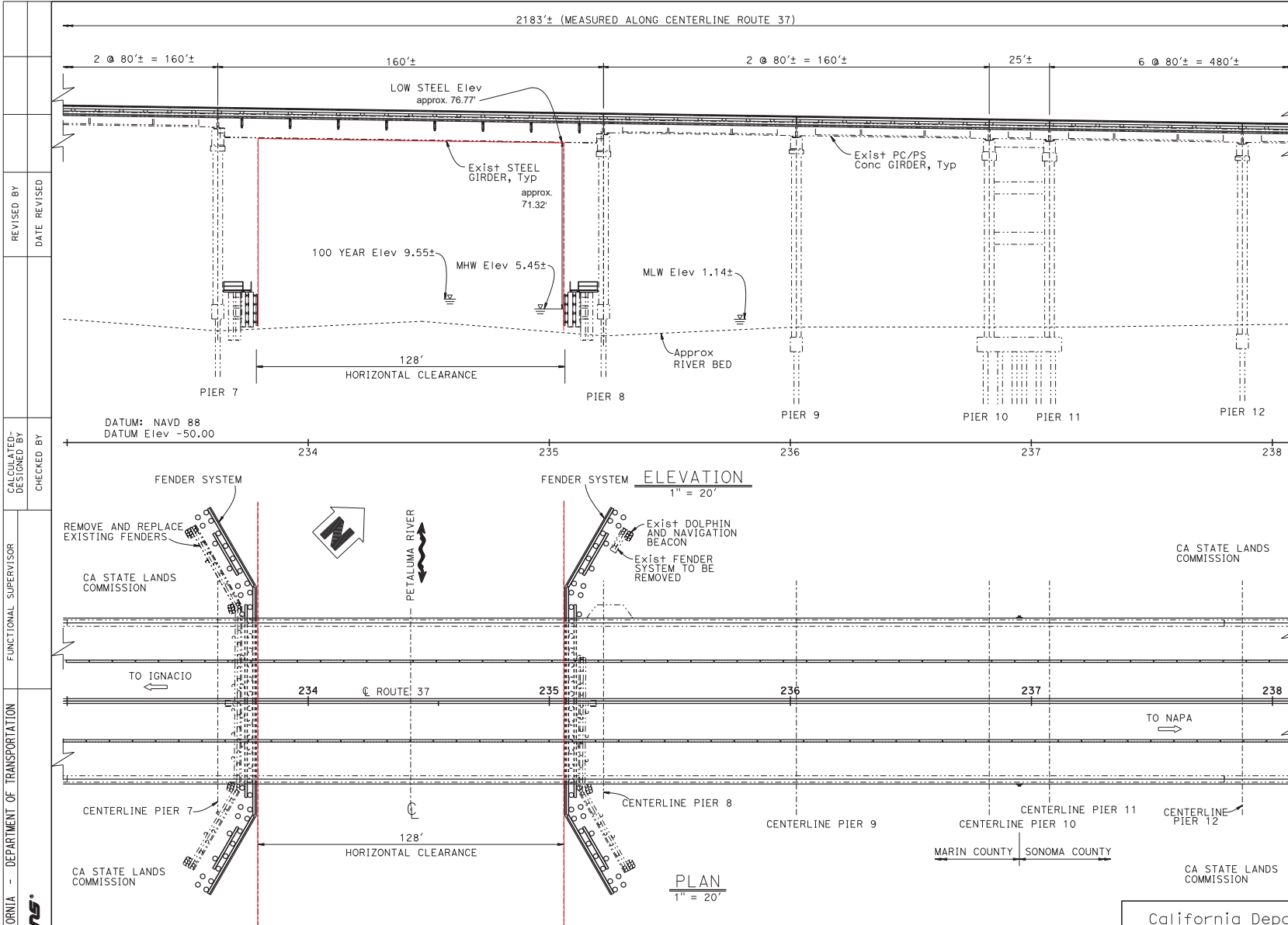

| | | | | | |
|------|--------|-------|--------------------------|-----------|--------------|
| DIST | COUNTY | ROUTE | POST MILES TOTAL PROJECT | SHEET No. | TOTAL SHEETS |
| 04 | Mrn | 37 | 14.5 | | |

Jason Phoen
 REGISTERED CIVIL ENGINEER DATE 2-18-25

THE STATE OF CALIFORNIA OR ITS OFFICERS OR AGENTS SHALL NOT BE RESPONSIBLE FOR THE ACCURACY OR COMPLETENESS OF SCANNED COPIES OF THIS PLAN SHEET.

REGISTERED PROFESSIONAL ENGINEER
 Jason R. Phoen
 No. 57553
 Exp. 2-31-25
 CIVIL
 STATE OF CALIFORNIA

REVISIONS:
 1. REVISED BY: DATE REVISED:
 2. CALCULATED BY: DESIGNED BY: CHECKED BY:
 3. FUNCTIONAL SUPERVISOR:
 4. STATE OF CALIFORNIA - DEPARTMENT OF TRANSPORTATION

CONCEPTUAL PLAN UTILIZED TO OBTAIN COAST GUARD PERMIT

California Department of Transportation
 Fender Replacement
 Petaluma River (State Route 37) Bridge
 Petaluma River, Mile 1.0
 At the Sonoma/Marin County line, California
 February 18, 2025
 Sheet 3 of 4



