



7 JULY 2023

## PUBLIC NOTICE 09-03-23

All interested parties are herein notified that the Commander, Ninth Coast Guard District, has received application materials dated 10 May 2023 from the New York State Department of Transportation (“NYSDOT”) for approval of location and plans for the replacement of a bridge across a navigable waterway of the United States.

**BRIDGE, WATERWAY AND LOCATION:** U.S. Route 11 Bridge, Bridge E-64, across the Erie Canal, mile 150.58, between the Cicero, Onondaga County, and Hastings, Oswego County, New York. This Erie Canal section is also referred to as the Oneida River and the Barge Canal.

**CHARACTER OF WORK:** NYSDOT proposes to replace the existing three-span fixed bridge with another three-span bridge with updated features. The existing bridge is 377.50-foot long from abutment-to-abutment, has an out-to-out width of 56.75-feet, and provides vertical and horizontal clearances as described below. The proposed replacement bridge would be another three-span structure located on the same alignment and footprint as the existing structure. It would be 413.50-foot long from abutment-to-abutment, have an out-to-out width of at least 57.25-foot over the navigation channel pending final design, and provide vertical and horizontal clearances as noted below. The purpose and need of the proposed project is to replace the current structure which is deteriorating and has exceeded its original design life.

In addition to proposing a permanent replacement structure, NYSDOT also proposes construction of a temporary bridge that would be located approximately on the same alignment as the existing structure and approximately 50.00-foot west. It would provide a detour to land traffic and removed upon completion of construction of the replacement structure. Existing piers would be removed to the mudline and replaced, existing abutments would be removed to finish ground, and the existing superstructure would be removed and replaced.

### MINIMUM NAVIGATIONAL CLEARANCES:

The proposed permanent bridge increases the horizontal clearance and matches the existing bridge’s vertical clearance. The temporary bridge matches the existing bridge’s clearances.

	Existing	Proposed Replacement	Proposed Temporary
Vertical	23.50-foot	24.23 feet at center, 23.20-feet at limit of navigation channel	23.50-foot
Horizontal	201.50-foot	240.00-foot	201.50-foot

**Datum:** Elevations referenced to Low Water Datum, 342.00-foot, Barge Canal Datum (“BCD”).

## ENVIRONMENTAL CONSIDERATIONS:

The Federal Highway Administration (“FHWA”) is the lead Federal agency for satisfying the requirements of the National Environmental Policy Act (NEPA). NYSDOT has recommended that FHWA classify the project as a Categorical Exclusion for Federal-aided highway projects. FHWA’s determination is forthcoming. The U.S. Coast Guard has tentatively determined that the proposed action will not have a significant impact for the purposes of NEPA for the project.

The need for water quality certification (“WQC”) in accordance with Section 401 of the Clean Water Act, as amended, is to be determined by the New York State Department of Environmental Conservation (“NYSDEC”). NYSDEC’s determination is forthcoming.

NYSDOT’s permit application indicates that no wetlands will be taken or affected by this project. The Coast Guard defers to the U.S. Army Corps of Engineers (“USACE”) regarding wetlands impact determinations. Their determination is forthcoming.

The bridge is located in the floodplain. The 100-year flood elevation is 374.20-feet, while elevation of the low member of the navigation span is 394.50-feet. Elevations are referenced to Barge Canal Datum.

## SOLICITATION OF COMMENTS:

Mariners are requested to comment on the proposed navigation clearances, placement of a bridge protective system and other navigational safety issues, including need for clearance gauges and extent of nighttime navigation to determine the need for bridge lighting. Interested parties are requested to express their views, in writing, on the proposed bridge project including its possible impacts to navigation.

We will forward comments of an environmental nature such as those regarding wildlife refuges, public parks, historic sites, wetlands, floodplain issues, air, water quality, environmental justice, etc. to FHWA. Comments will be received for the record at the address noted in the header or via email to [michael.o.walker2@uscg.mil](mailto:michael.o.walker2@uscg.mil) through **August 11, 2023**.

Map of location and plans attached.



W. B. STANIFER  
Chief, Bridge Branch  
U.S. Coast Guard  
By Direction

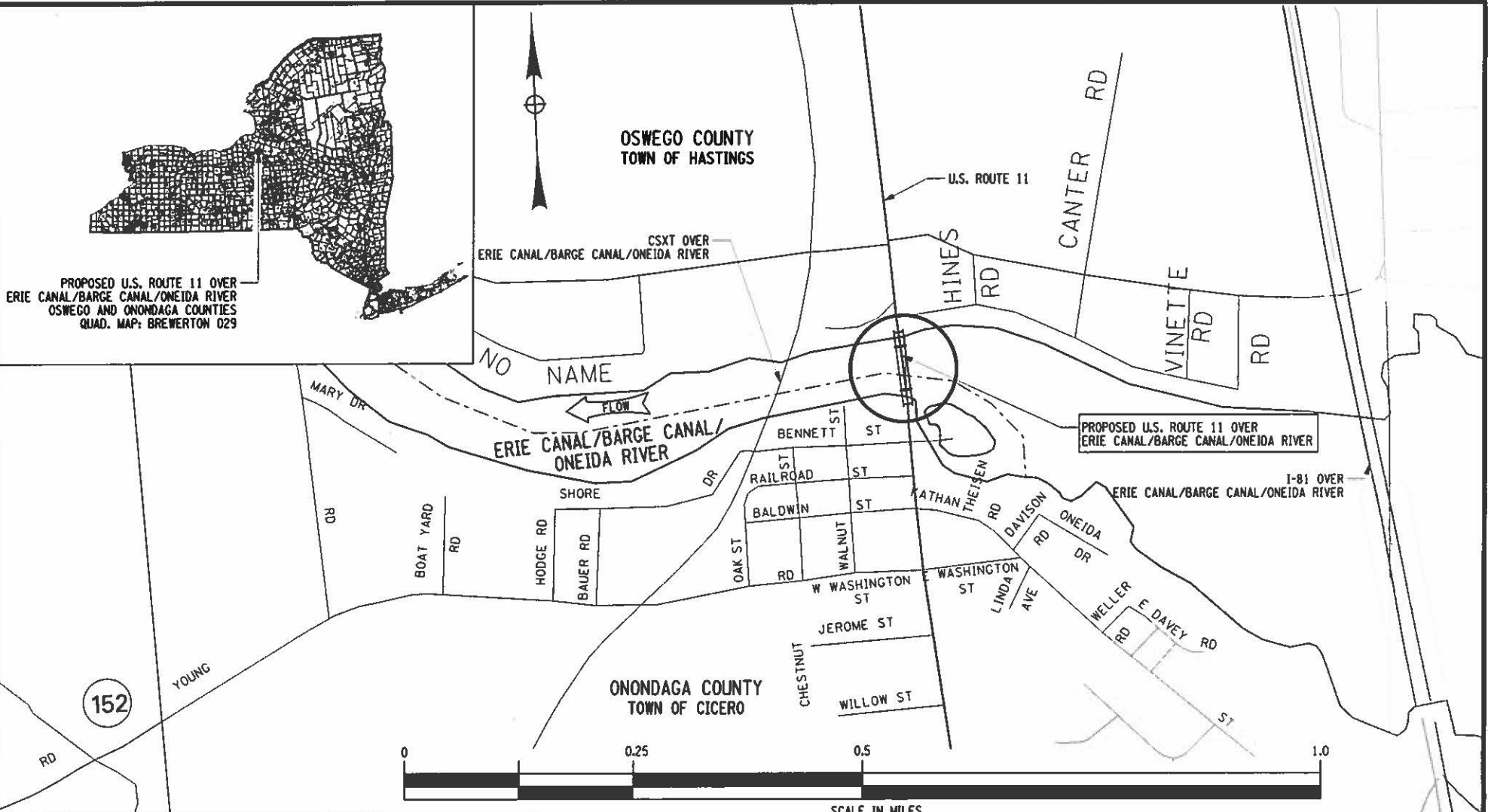

AFFIX SEAL: 6/28/2023  
ON:

ALTERED BY:  
ON:



IT IS A VIOLATION OF LAW FOR ANY PERSON, UNLESS THEY ARE ACTING UNDER THE DIRECTION OF A LICENSED PROFESSIONAL ENGINEER, ARCHITECT, LANDSCAPE ARCHITECT, OR LAND SURVEYOR, TO ALTER AN ITEM IN ANY WAY. IF AN ITEM BEARING THE STAMP OF A LICENSED PROFESSIONAL IS ALTERED, THE ALTERING ENGINEER, ARCHITECT, LANDSCAPE ARCHITECT, OR LAND SURVEYOR SHALL STAMP THE DOCUMENT AND INCLUDE THE NOTATION "ALTERED BY" FOLLOWED BY THEIR SIGNATURE, THE DATE OF SUCH ALTERATION, AND A SPECIFIC DESCRIPTION OF THE ALTERATION.

ALL DIMENSIONS ARE IN FT UNLESS OTHERWISE NOTED



Department of  
Transportation

PROPOSED U.S. ROUTE 11  
AND TEMPORARY BRIDGE OVER  
ERIE CANAL/BARGE CANAL/ONEIDA RIVER

CONCEPTUAL PLANS UTILIZED  
TO OBTAIN COAST GUARD  
BRIDGE PERMIT

PIN 3043.65 REGION: 03  
COUNTIES: OSWEGO & ONONDAGA

MILE POINT OF BRIDGE LOCATION: 150.58

DATE: 06/28/2023

CONSULTANT/AGENT: N/A

TOWNS OF CICERO AND HASTINGS

SHEET: 1 OF 4

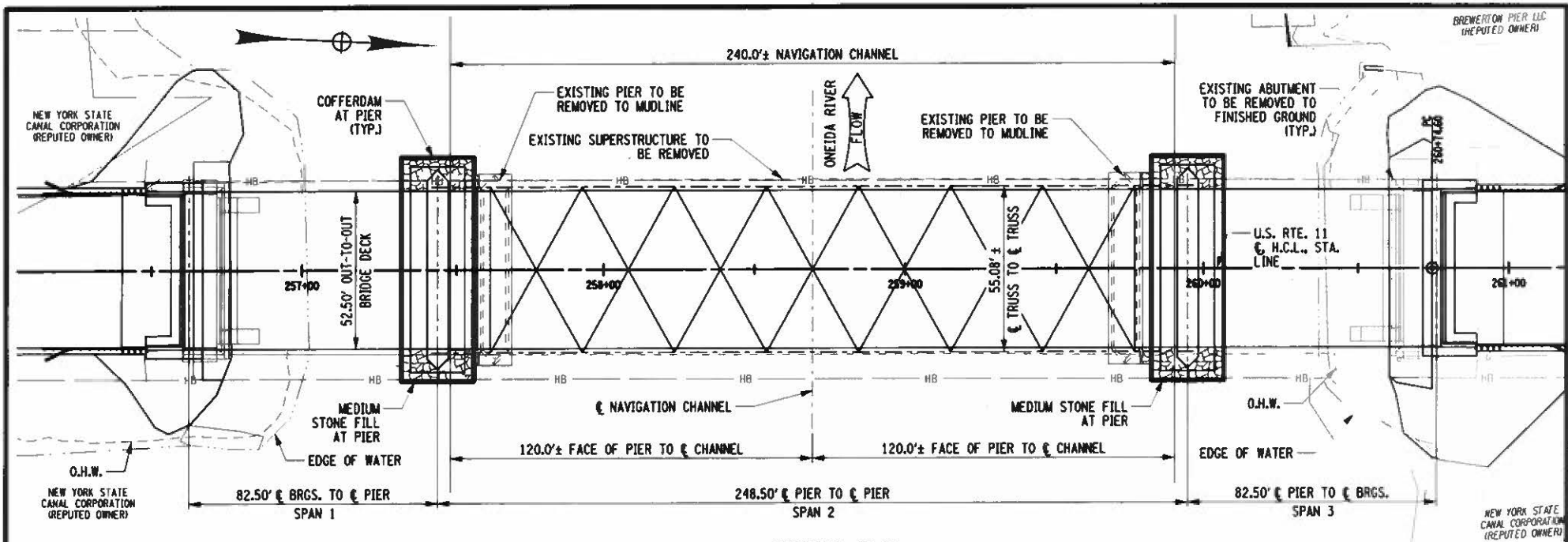

GENERAL PLAN

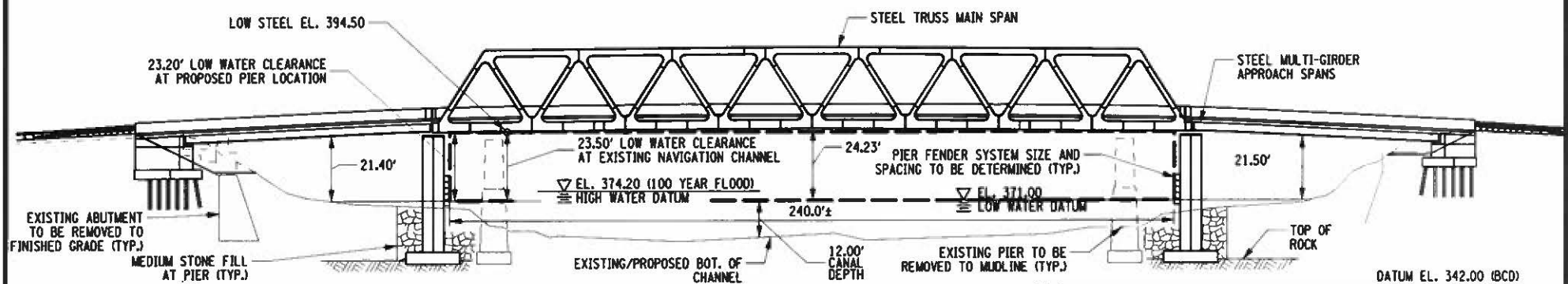

BRIDGE ELEVATION

AFFIX SEAL ON: 6/28/2023

ALTERED BY: ON:

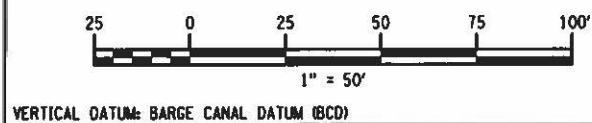

IT IS A VIOLATION OF LAW FOR ANY PERSON, UNLESS THEY ARE ACTING UNDER THE DIRECTION OF A LICENSED PROFESSIONAL ENGINEER, ARCHITECT, LANDSCAPE ARCHITECT, OR LAND SURVEYOR, TO ALTER AN ITEM IN ANY WAY. IF AN ITEM BEARING THE STAMP OF A LICENSED PROFESSIONAL IS ALTERED, THE ALTERING ENGINEER, ARCHITECT, LANDSCAPE ARCHITECT, OR LAND SURVEYOR SHALL STAMP THE DOCUMENT AND INCLUDE THE NOTATION "ALTERED BY" FOLLOWED BY THEIR SIGNATURE, THE DATE OF SUCH ALTERATION, AND A SPECIFIC DESCRIPTION OF THE ALTERATION.

ALL DIMENSIONS ARE IN FT UNLESS OTHERWISE NOTED

**NEW YORK STATE OF OPPORTUNITY.** Department of Transportation

PROPOSED U.S. ROUTE 11 AND TEMPORARY BRIDGE OVER ERIE CANAL/BARGE CANAL/ONEIDA RIVER

CONCEPTUAL PLANS UTILIZED TO OBTAIN COAST GUARD BRIDGE PERMIT	PIN 3043.65	REGION: 03
MILE POINT OF BRIDGE LOCATION: 150.58		
DATE: 06/28/2023	CONSULTANT/AGENT: N/A	
TOWNS OF CICERO AND HASTINGS		SHEET: 2 OF 4

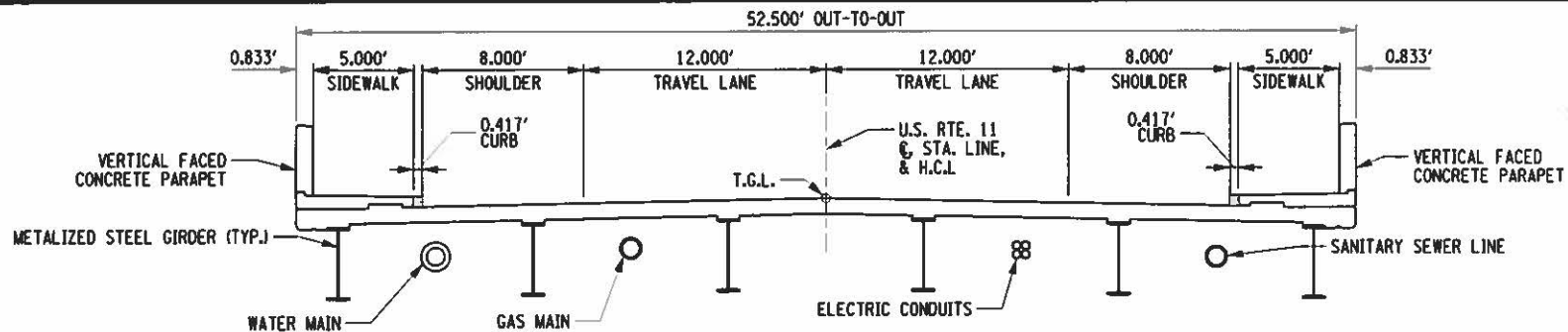

BRIDGE SECTION  
SPANS 1 & 3

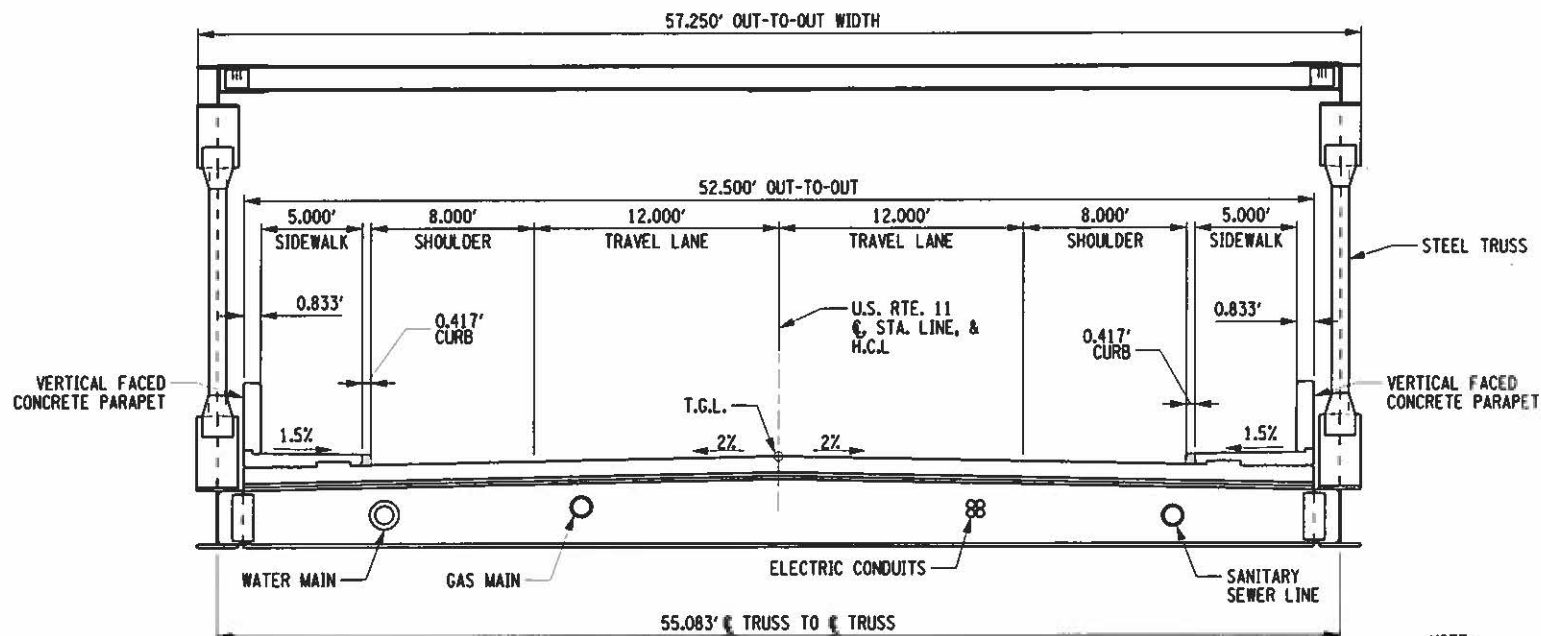

BRIDGE SECTION  
SPAN 2

NOTE:  
UTILITY LOCATIONS ARE PENDING

AFFIX SEAL:  
ON: 6/28/2023

ALTERED BY:  
ON: \_\_\_\_\_



IT IS A VIOLATION OF LAW FOR ANY PERSON, UNLESS THEY ARE ACTING UNDER THE DIRECTION OF A LICENSED PROFESSIONAL ENGINEER, ARCHITECT, LANDSCAPE ARCHITECT, OR LAND SURVEYOR, TO ALTER AN ITEM IN ANY WAY. IF AN ITEM BEARING THE STAMP OF A LICENSED PROFESSIONAL IS ALTERED, THE ALTERING ENGINEER, ARCHITECT, LANDSCAPE ARCHITECT, OR LAND SURVEYOR SHALL STAMP THE DOCUMENT AND INCLUDE THE NOTATION "ALTERED BY" FOLLOWED BY THEIR SIGNATURE, THE DATE OF SUCH ALTERATION, AND A SPECIFIC DESCRIPTION OF THE ALTERATION.

ALL DIMENSIONS ARE IN FT UNLESS OTHERWISE NOTED



Department of  
Transportation

PROPOSED U.S. ROUTE 11  
AND TEMPORARY BRIDGE OVER  
ERIE CANAL/BARGE CANAL/ONEIDA RIVER

CONCEPTUAL PLANS UTILIZED TO OBTAIN COAST GUARD BRIDGE PERMIT	PIN 3043.65	REGION: 03
	COUNTIES: OSWEGO & ONONDAGA	

MILE POINT OF BRIDGE LOCATION: 150.58	
DATE: 06/28/2023	CONSULTANT/AGENT: N/A
TOWNS OF CICERO AND HASTINGS	SHEET: 3 OF 4

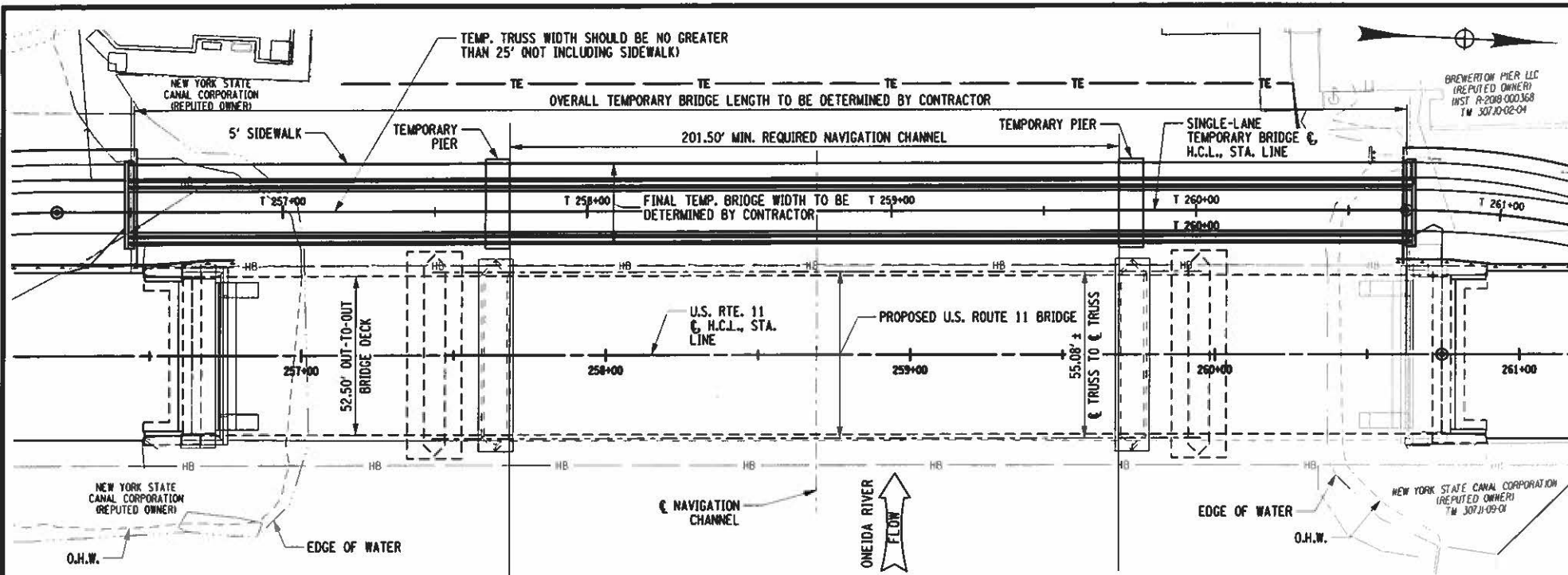

TEMPORARY BRIDGE PLAN

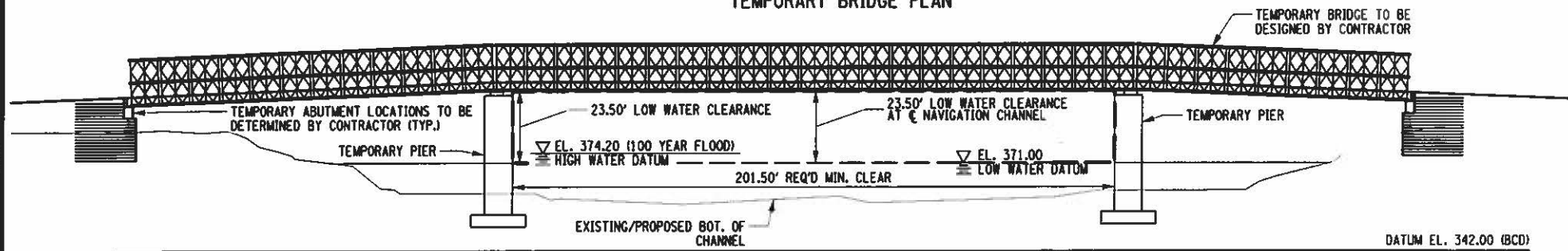

TEMPORARY BRIDGE ELEVATION

AFFIX SEAL: 6/28/2023  
ON:

ALTERED BY:  
ON:

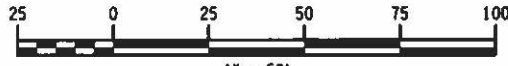

VERTICAL DATUM: BARGE CANAL DATUM (BCD)

IT IS A VIOLATION OF LAW FOR ANY PERSON, UNLESS THEY ARE ACTING UNDER THE DIRECTION OF A LICENSED PROFESSIONAL ENGINEER, ARCHITECT, LANDSCAPE ARCHITECT, OR LAND SURVEYOR, TO ALTER AN ITEM IN ANY WAY. IF AN ITEM BEARING THE STAMP OF A LICENSED PROFESSIONAL IS ALTERED, THE ALTERING ENGINEER, ARCHITECT, LANDSCAPE ARCHITECT, OR LAND SURVEYOR SHALL STAMP THE DOCUMENT AND INCLUDE THE NOTATION "ALTERED BY" FOLLOWED BY THEIR SIGNATURE, THE DATE OF SUCH ALTERATION, AND A SPECIFIC DESCRIPTION OF THE ALTERATION.

ALL DIMENSIONS ARE IN FT UNLESS OTHERWISE NOTED



PROPOSED U.S. ROUTE 11 AND TEMPORARY BRIDGE OVER ERIE CANAL/BARGE CANAL/ONEIDA RIVER

CONCEPTUAL PLANS UTILIZED TO OBTAIN COAST GUARD BRIDGE PERMIT	PIN 3043.65	REGION: 03
MILE POINT OF BRIDGE LOCATION: 150.58		
DATE: 06/28/2023	CONSULTANT/AGENT: N/A	
TOWNS OF CICERO AND HASTINGS	SHEET: 4 OF 4	