



16591
25 JUL 2025

PUBLIC NOTICE D05PN-06-2025

All interested parties are notified that an application was received on May 3, 2024, from Amtrak by the Commander, Coast Guard East District, for approval of the location and plans for construction of two new fixed railroad bridges over a navigable waterway of the United States.

WATERWAY AND LOCATION: Susquehanna River, mile 1.0, between Havre de Grace, Harford County and Perryville, Cecil, MD.

CHARACTER OF WORK: The proposed project consists of demolition and replacement of the existing Susquehanna River Railroad swing-span drawbridge and construction of two new fixed, two-track river bridges with accompanying piers and abutment, along with redesigned approaches and interlockings, track realignment, and installation of new embankments and retaining walls. The existing swing-span drawbridge will be removed to a minimum of two feet below the mudline. The purpose of the project is to improve rail services reliability and safety, improve operational flexibility and accommodate future freight, commuter, intercity, and high-speed rail operations, and maintain adequate marine navigation and improve safety along the Susquehanna River.

MINIMUM NAVIGATIONAL CLEARANCES:

<u>Existing</u>	<u>Proposed</u>
Vertical Clearance:	Vertical Clearance:
Open – Unlimited	60.35 feet above mean high water
Closed – 52 feet above mean high water	
Horizontal Clearance: (normal to axis of the channel) 100 feet between the pilings.	Horizontal Clearance: (normal to axis of the channel) 272.27 feet between fenders.

North American Vertical Datum of 1988 (NAVD88) (Existing and Proposed bridges)

ENVIRONMENTAL CONSIDERATIONS:

The Federal Railway Administration (FRA) is the lead Federal agency for compliance with the National Environmental Policy Act (NEPA). The FRA is acting on behalf of the U. S. Coast Guard (USCG) for all applicable environmental control laws and Executive Orders. The FRA approved an Environmental Assessment (EA) on March 2, 2017 and Re-evaluation on October 2, 2023, and issued a Finding of No Significant Impact dated May 31, 2017. The USCG has tentatively determined that the environmental documentation approved and issued by the FRA is adequate for USCG bridge permitting purposes and intends to adopt the EA and issue a USCG FONSI. Environmental documents are available for review at the address in the letterhead above, Monday through Friday (except Federal holidays), from 8 a.m. to 4:30 p.m.

The bridge is located in the floodplain. The 100-year flood elevation level is + 4.8 feet from datum and low steel of the bridge in the navigation span is elevation +60.88 feet from datum. Elevations are referenced to NAVD88 datum.

A water quality certificate has been applied for from the Maryland Department of the Environment on May 8, 2025.

The bridge construction site is inside of a designated Coastal Zone Management area. The applicant provided the Maryland Department of Environment (MDE) with the project location information. MDE issued a finding on March 26, 2025, that the project is consistent with the state's Coastal Zone Management Plan.

Comments received in response to this notice concerning environmental control laws and Executive Orders will be forwarded to the FRA as Lead Federal Agency.

SOLICITATION OF COMMENTS:

Mariners are requested to provide navigational information, such as the sizes and types of vessels presently owned and operated on the waterway and nature of navigation (including the extent of nighttime navigation) on the waterway. Mariners are requested to comment on the navigational clearances and need for bridge protective systems, clearance gauges, and navigational lighting on the proposed bridge.

Interested parties are requested to express their views, in writing, on the proposed bridge project, giving sufficient detail to establish a clear understanding of their reasons for support of, or opposition to, the proposed project. Comments will be received for the record at the office of Commander (dpb), Coast Guard East District, 431 Crawford Street, Portsmouth, VA 23704-5004 at D5Portsmouth-BridgesPublicNotice@uscg.mil through **25 AUG 2025**.

PITTS.HAL.R. Digitally signed by
PITTS.HAL.R.1121267272
1121267272 Date: 2025.07.23
12:03:56 -04'00'
HAL R. PITTS
Bridge Program Manager
By direction

Attachments: (1) Location/Vicinity Maps and Plan Sheets

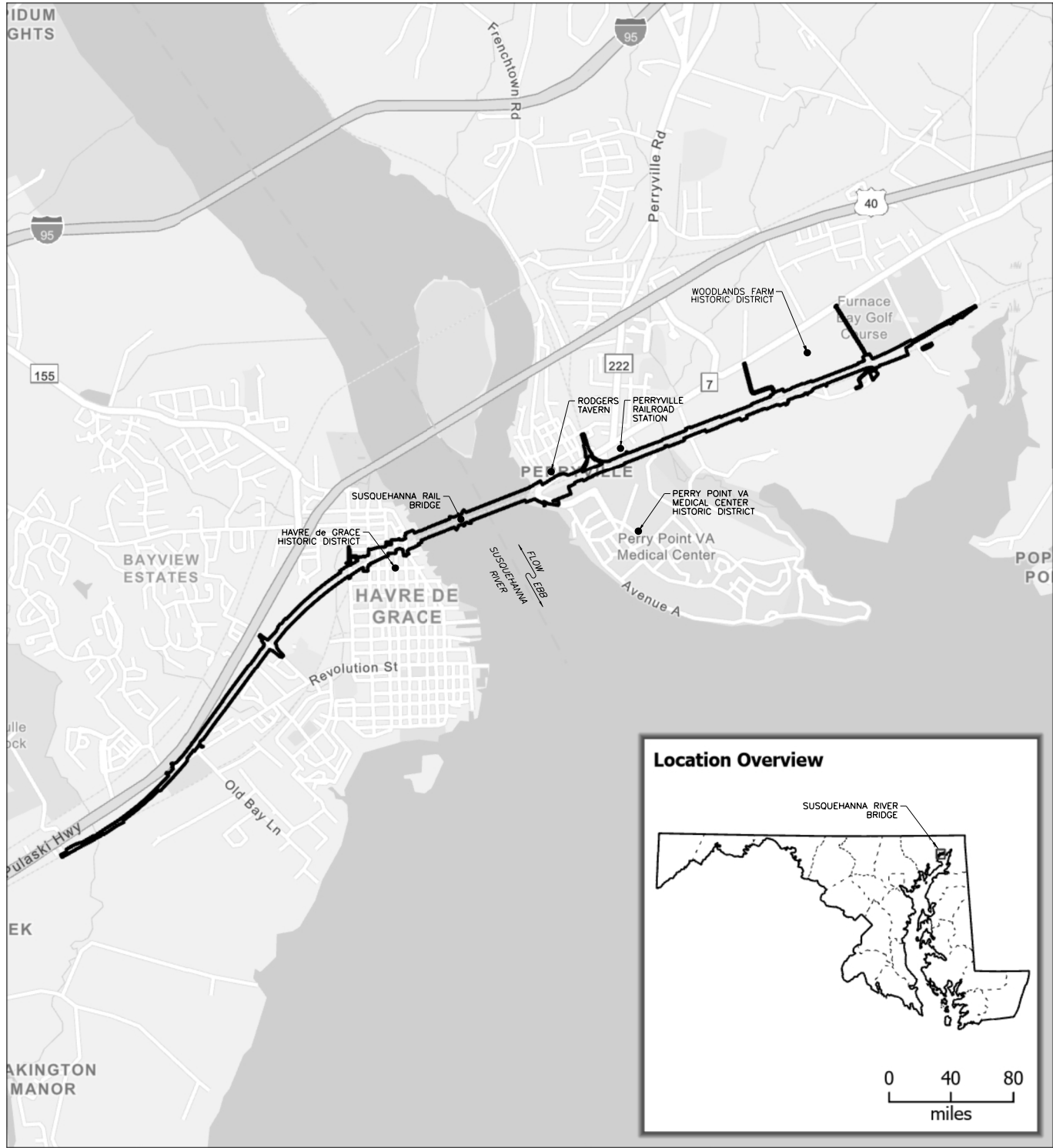

Legend

- Limit of Disturbance
- Historic Point of Interest

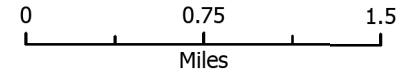

Location Overview

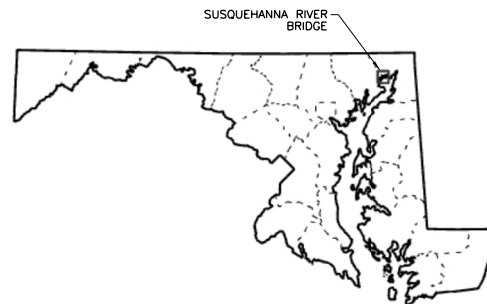

AMTRAK	
HNTB CORPORATION	
SUSQUEHANNA RIVER BRIDGE ACROSS THE SUSQUEHANNA RIVER BETWEEN PERRYVILLE AND HAYRE DE GRACE, MD M.P. NO. 1.0	
LOCATION/VICINITY MAP	
JULY 10, 2025	SHEET 1 OF 5

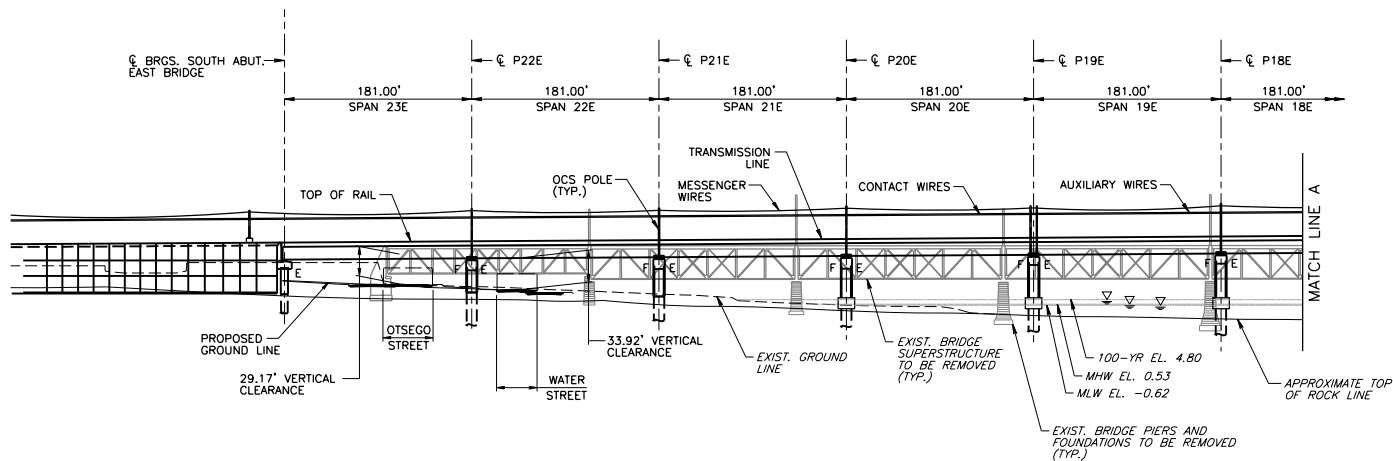
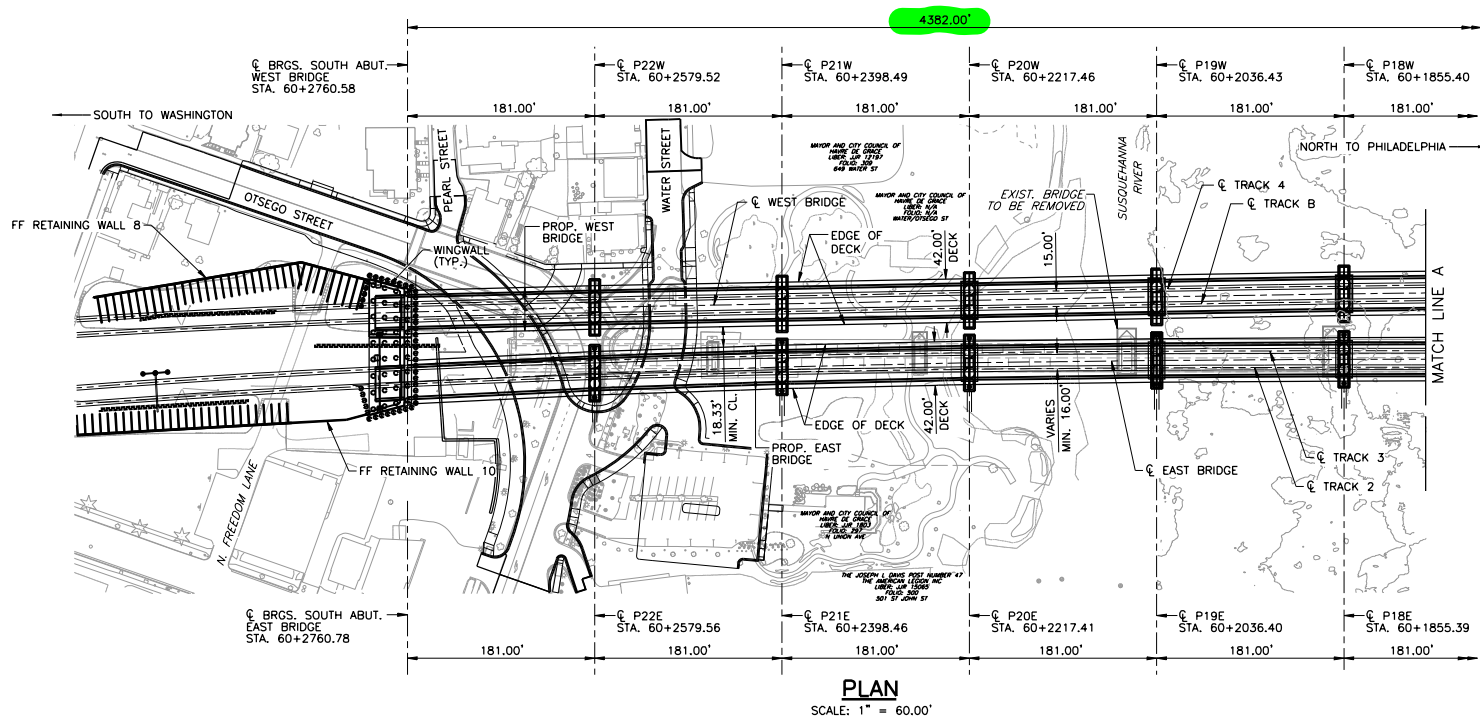

- NOTES:**
- STATIONS MEASURED ALONG C TRACK 2 FOR EAST BRIDGE AND ALONG C TRACK 4 FOR WEST BRIDGE, PHASE 2 ALIGNMENT.
 - ALL DATUM SHALL BE AS FOLLOWS:
VERTICAL - NORTH AMERICAN VERTICAL DATUM NAVD 88
HORIZONTAL - NORTH AMERICAN DATUM NAD 83/91 OR NEWER AS PUBLISHED ON THE NATIONAL GEODETIC SURVEY DATA SHEET
 - DREDGING OF THE RIVER BOTTOM IS NOT PERMITTED.
 - ALL BACKFILL IS BELOW EXISTING RIVER BOTTOM. NO FILL, BACKFILL, OR RIP-RAP MATERIALS SHALL BE PLACED ABOVE EXISTING RIVER BOTTOM.
 - AMOUNT OF FILL BELOW MHW IS AS FOLLOWS:
NEW FILL = 17,344 CY
REMOVED FILL = 14,340 CY
NET FILL = 3,004 CY
THIS INCLUDES AREA OF CONCRETE PIERS BETWEEN MHW AND EXISTING RIVER BOTTOM.

0 60 120
SCALE: 1" = 60'

AMTRAK	
HNTB CORPORATION	
SUSQUEHANNA RIVER BRIDGE ACROSS THE SUSQUEHANNA RIVER BETWEEN PERRYVILLE AND HAYVE DE GRACE, MD M.P. NO. 1.0	
GENERAL PLAN AND ELEVATION 1 OF 3	
JULY 10, 2025	SHEET 2 OF 5

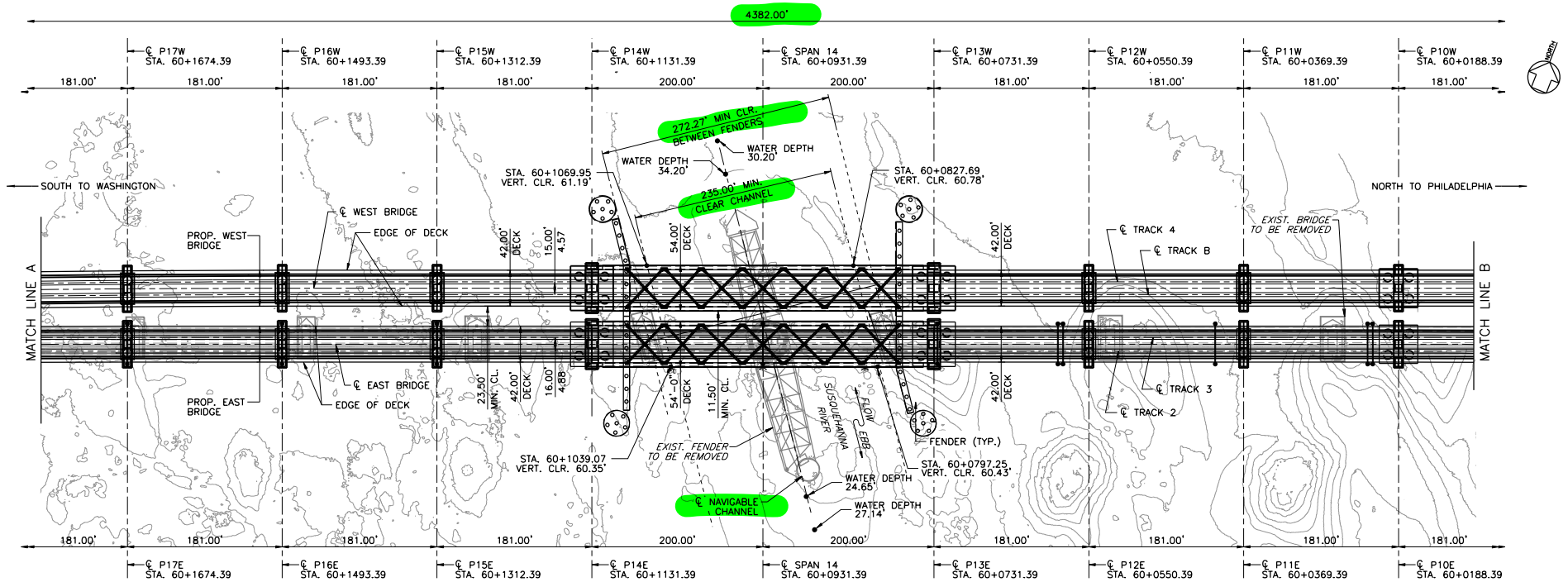

PLAN
SCALE: 1" = 60.00'

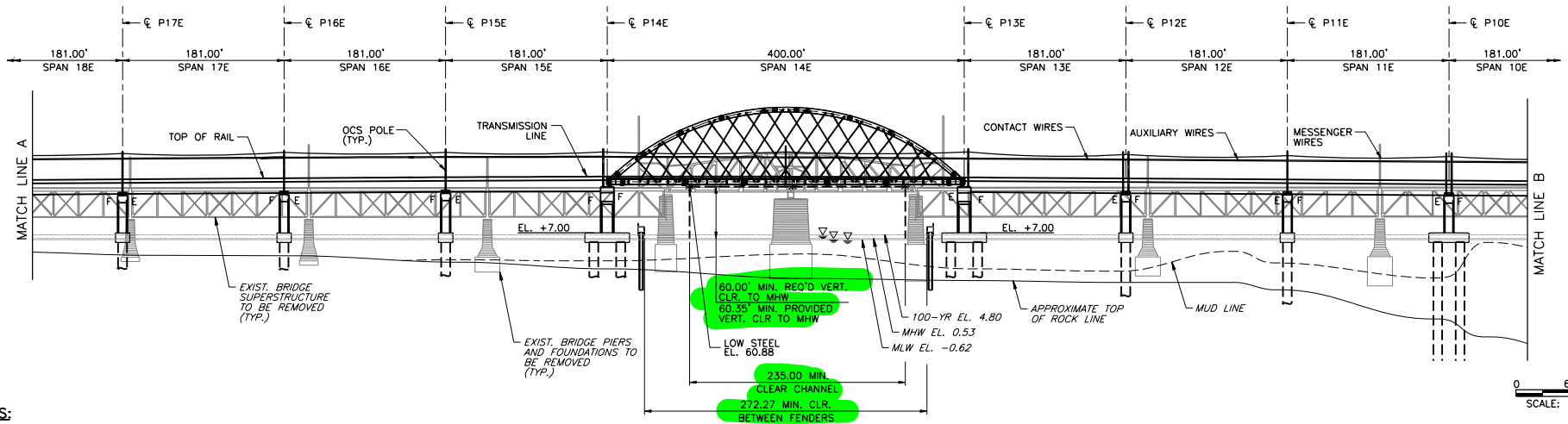

ELEVATION - EAST BRIDGE
SCALE: 1" = 60.00'

NOTES:

- STATIONS MEASURED ALONG C TRACK 2 FOR EAST BRIDGE AND ALONG C TRACK 4 FOR WEST BRIDGE, PHASE 2 ALIGNMENT.
- ALL DATUM SHALL BE AS FOLLOWS:
VERTICAL - NORTH AMERICAN VERTICAL DATUM NAVD 88
HORIZONTAL - NORTH AMERICAN DATUM NAD 83/91 OR NEWER AS PUBLISHED ON THE NATIONAL GEODETIC SURVEY DATA SHEET
- DREDGING OF THE RIVER BOTTOM IS NOT PERMITTED.

- ALL BACKFILL IS BELOW EXISTING RIVER BOTTOM. NO FILL, BACKFILL, OR RIP-RAP MATERIALS SHALL BE PLACED ABOVE EXISTING RIVER BOTTOM.
- AMOUNT OF FILL BELOW MHW IS AS FOLLOWS:
NEW FILL = 17,344 CY
REMOVED FILL = 14,340 CY
NET FILL = 3,004 CY
THIS INCLUDES AREA OF CONCRETE PIERS BETWEEN MHW AND EXISTING RIVER BOTTOM.

0 60 120
SCALE: 1" = 60'

AMTRAK	
HNTB CORPORATION	
SUSQUEHANNA RIVER BRIDGE ACROSS THE SUSQUEHANNA RIVER BETWEEN PERRYVILLE AND HAYVE DE GRACE, MD M.P. NO. 1.0	
GENERAL PLAN AND ELEVATION 2 OF 3	
JULY 10, 2025	SHEET 3 OF 5

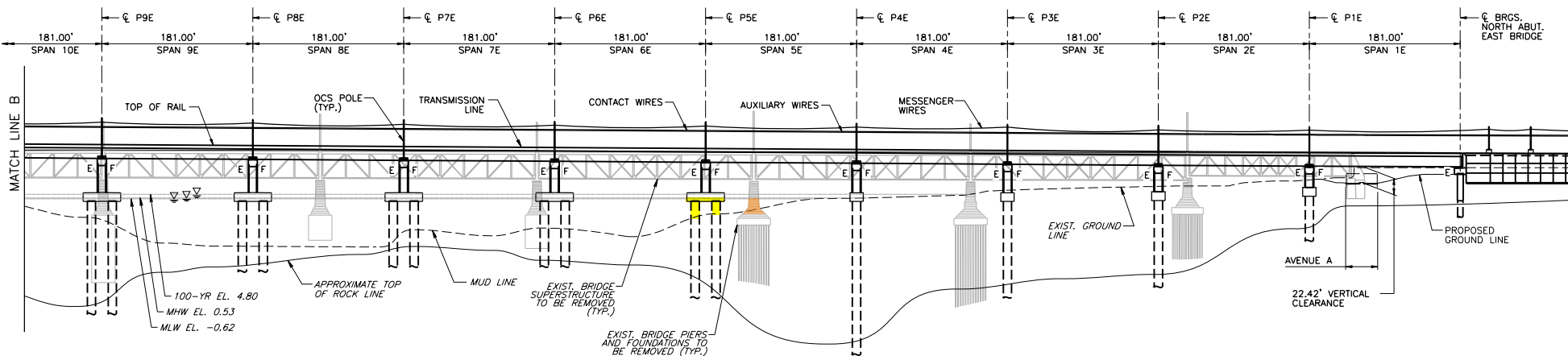
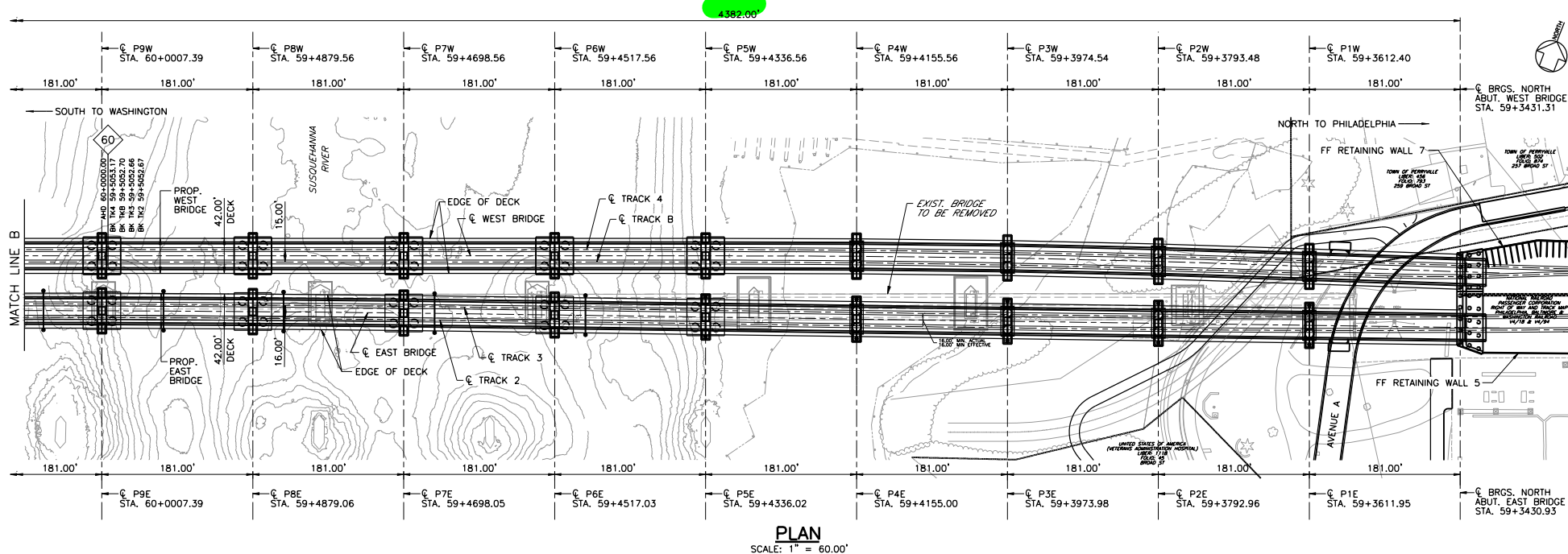

NOTES:

- STATIONS MEASURED ALONG C TRACK 2 FOR EAST BRIDGE AND ALONG C TRACK 4 FOR WEST BRIDGE, PHASE 2 ALIGNMENT.
- ALL DATUM SHALL BE AS FOLLOWS:
VERTICAL - NORTH AMERICAN VERTICAL DATUM NAVD 88
HORIZONTAL - NORTH AMERICAN DATUM NAD 83/91 OR NEWER AS PUBLISHED ON THE NATIONAL GEODETIC SURVEY DATA SHEET
- DREDGING OF THE RIVER BOTTOM IS NOT PERMITTED.
- ALL BACKFILL IS BELOW EXISTING RIVER BOTTOM. NO FILL, BACKFILL, OR RIP-RAP MATERIALS SHALL BE PLACED ABOVE EXISTING RIVER BOTTOM.
- AMOUNT OF FILL BELOW MHW IS AS FOLLOWS:
NEW FILL = 17,344 CY
REMOVED FILL = 14,340 CY
NET FILL = 3,004 CY
THIS INCLUDES AREA OF CONCRETE PIERS BETWEEN MHW AND EXISTING RIVER BOTTOM.

ELEVATION - EAST BRIDGE

SCALE: 1" = 60.00'

0 60 120
SCALE: 1" = 60'

AMTRAK	
HNTB CORPORATION	
SUSQUEHANNA RIVER BRIDGE ACROSS THE SUSQUEHANNA RIVER BETWEEN PERRYVILLE AND HAYVE DE GRACE, MD M.P. NO. 1.0	
GENERAL PLAN AND ELEVATION 3 OF 3	
JULY 10, 2025	SHEET 4 OF 5

