



Commander
United States Coast Guard
First District

408 Atlantic Av.
Boston, MA 02110
Staff Symbol: dpb
Phone: 617-833-1311

June 6, 2024

PUBLIC NOTICE 1-207-24

All interested parties are herein notified that the Commander, First Coast Guard District, has received application materials dated January 23, 2024, from the Massachusetts Department of Transportation for approval of location and plans for replacement of a bridge over a navigable waterway of the United States.

BRIDGE, WATERWAY AND LOCATION: Route 28 Bridge across the Bass River, mile 1.7, between West Dennis and South Yarmouth in Barnstable County, Massachusetts.

CHARACTER OF WORK: The project will replace the existing Route 28 (Main Street) Bridge which is nearing the end of its useful life and has been identified as structurally deficient. The replacement bridge will be constructed in phases. Vehicular traffic on the existing bridge will be shifted to the middle to allow for the removal and replacement of first the northern portion of the bridge then the southern portion of the bridge. Once complete, traffic will be shifted to the new bridge and the middle portions will be demolished and replaced. This will be followed by the construction of the southern sidewalk. The superstructure of the existing bridge will be removed in its entirety. Existing piles in the navigation channel will be removed to 3 feet below the mudline. All other piles will be removed to 2 feet below the mudline.

The proposed replacement bridge will have clearances as described in the table below. These clearances are an increase from current clearances over this section of the waterway at or near this mile. Vertical clearance is from low member elevation to mean high water.

	Existing	Proposed
Vertical	15.14 feet MHW	15.5 feet MHW
Horizontal	30 feet	45 feet

Datum: NAVD88

ENVIRONMENTAL CONSIDERATIONS:

The Federal Highways Administration (FHWA) is the lead Federal agency for satisfying the requirements of the National Environmental Policy Act (NEPA). The FHWA is acting on behalf of the Coast Guard for all environmental control laws. A FHWA Categorical Exclusion dated 16 February, 2024, was issued pursuant to NEPA, as amended. The U.S. Coast Guard has tentatively determined that the proposed action will not have a significant impact for the purposes of NEPA and a Categorical Exclusion can be issued.

A water quality certification in accordance with Section 401 of the Clean Water Act, as amended, for this project was applied for from the Massachusetts Department of Environmental Protection on January 23, 2024. No wetlands will be taken or affected by this project.

The bridge is located in the floodplain. The 100-year flood elevation is 13 feet. The elevation of the low member of the navigation span is 17 feet. Elevations are referenced to NAVD88 datum. Approximately 10 cubic yards of fill material will be placed below mean high water level for the construction of the bridge and approaches.

SOLICITATION OF COMMENTS:

Mariners are requested to comment on the proposed navigation clearances, placement of a bridge protective system and other navigational safety issues, including need for clearance gauges and extent of nighttime navigation to determine the need for bridge lighting. Interested parties are requested to express their views, in writing, on the proposed bridge project including its possible impacts to navigation.

We will forward comments of an environmental nature such as those regarding wildlife refuges, public parks, historic sites, wetlands, floodplain issues, air, water quality, environmental justice, etc., to the Federal Highways Administration. Comments will be received for the record at the address noted in the header or via email (SMB-D1Boston-Bridges-PublicNotices@uscg.mil) through July 8, 2024.

Map of location and plans attached.

Donna A. Fisher
Bridge Administrator
By direction of the Commander,
First Coast Guard District



LOCUS PLAN
N.T.S.

PROJECT
LOCATION

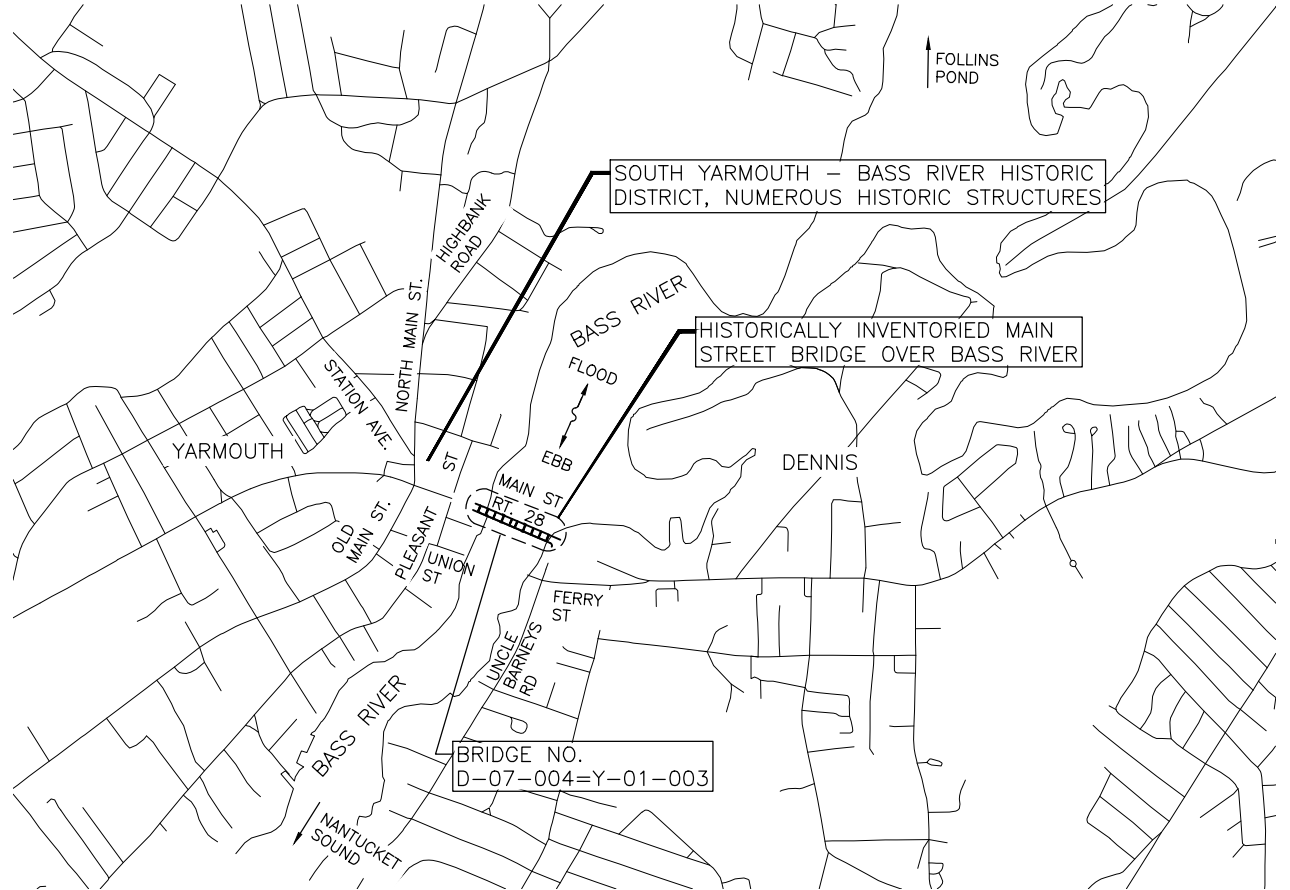

PROPOSED BRIDGE LOCATION PLAN

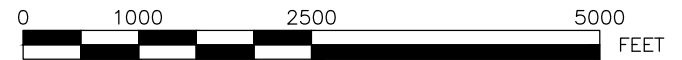

CONCEPTUAL PLANS UTILIZED TO
OBTAIN COAST GUARD BRIDGE PERMIT



5/28/24

SIGNATURE

5/28/24

DATE

USCG BRIDGE PERMIT PLANS
WEST DENNIS - SOUTH YARMOUTH
RT 28 (MAIN STREET) BRIDGE
ACROSS BASS RIVER
BASS RIVER CL STA 1+66.77
RIVER MILE (1.7)

DESCRIPTION 09/01/2020

BASS RIVER

CL STA 1+66.77
DENNIS, MA. - YARMOUTH MA
BARNSTABLE COUNTY

CONSULTANT/AGENT

HDR

APPLICANT/OWNER

MASSDOT

DATE

SHEET NO.

1 OF 6

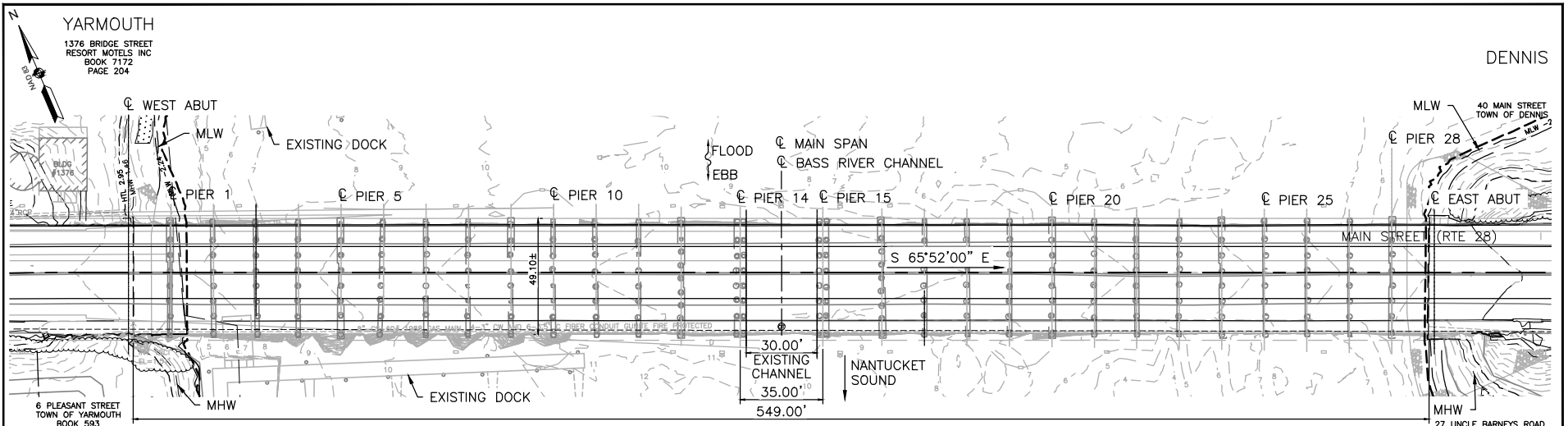

EXISTING BRIDGE PLAN

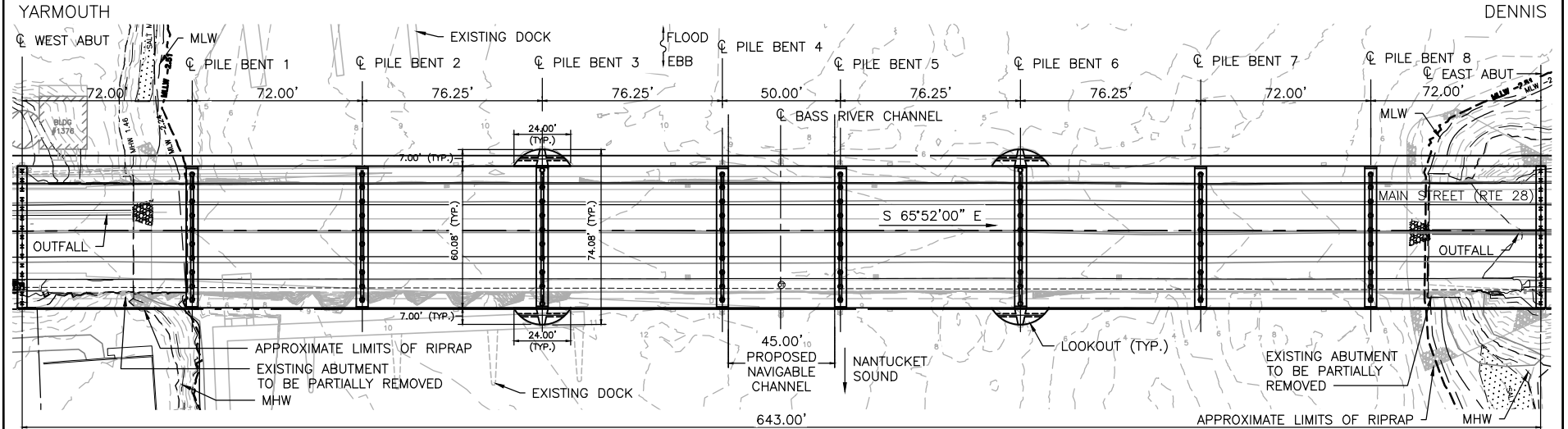

PROPOSED BRIDGE PLAN

NOTES:

1. FEMA MAP 100 YEAR FLOOD EL. +13 NAVD88.
2. THE BRIDGE HAS BEEN DESIGNED IN ACCORDANCE WITH THE REQUIREMENTS OF AASHTO LRFD BRIDGE DESIGN SPECIFICATIONS.
3. EXISTING BRIDGE WILL BE REMOVED IN TO THE EXTENTS SHOWN.
4. VERTICAL ELEVATIONS ARE BASED ON NORTH AMERICAN VERTICAL DATUM (NAVD) OF 1988. HORIZONTAL GEOMETRY IS BASED ON NORTH AMERICAN HORIZONTAL DATUM 1983-NAD83 (2011).

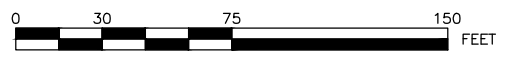

<p>5/28/24</p> <p>SIGNATURE</p> <p>5/28/24</p> <p>DATE</p>	<p>USCG BRIDGE PERMIT PLANS WEST DENNIS – SOUTH YARMOUTH RT 28 (MAIN STREET) BRIDGE ACROSS BASS RIVER BASS RIVER CL STA 1+66.77 RIVER MILE (1.7)</p>	
	<p>DESCRIPTION</p> <p>BASS RIVER CL STA 1+66.77 DENNIS, MA. – YARMOUTH MA BARNSTABLE COUNTY</p>	<p>09/01/2020</p> <p>DATE</p>
	<p>CONSULTANT/AGENT</p> <p>HDR</p> <p>APPLICANT/OWNER</p> <p>MASSDOT</p>	<p>SHEET NO.</p> <p>2 OF 6</p>
	<p>MASSDOT</p>	

08/14 BRIDGE GUARD PLAN AND ELEVATION DWG. Printed on 28 May 2024
 XXXXX Structural Specialist (S) - DD-Month-YYYY
 XXXXX Structural Specialist (S) - DD-Month-YYYY

08/14 BR/COST GUARD PLAN AND ELEVATION DWG Printed on 28 May 2024
 XXXXX Structural Submittal (B) DD-Mon-YYYY
 XXXXX Structural Submittal (B) DD-Mon-YYYY
 XXXXX Structural Submittal (B) DD-Mon-YYYY

YARMOUTH

DENNIS

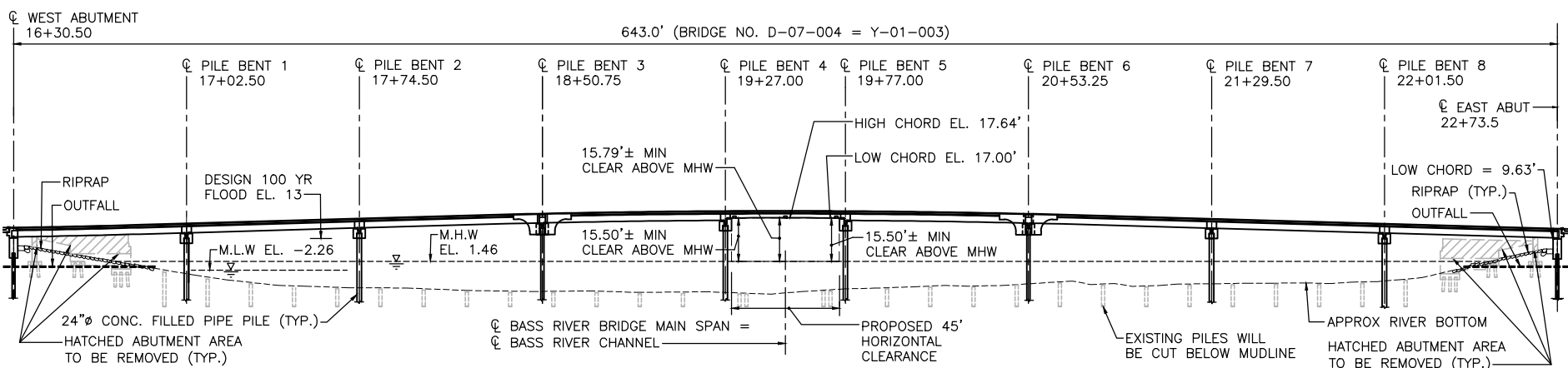

PROPOSED BRIDGE ELEVATION

NOTES:

- FEMA MAP 100 YEAR FLOOD EL. +13 NAVD88.
- THE BRIDGE HAS BEEN DESIGNED IN ACCORDANCE WITH THE REQUIREMENTS OF AASHTO LRFD BRIDGE DESIGN SPECIFICATIONS.
- EXISTING BRIDGE WILL BE REMOVED IN TO THE EXTENTS SHOWN.
- VERTICAL ELEVATIONS ARE BASED ON NORTH AMERICAN VERTICAL DATUM (NAVD) OF 1988. HORIZONTAL GEOMETRY IS BASED ON NORTH AMERICAN HORIZONTAL DATUM 1983-NAD83 (2011).





 5/28/24
 SIGNATURE
 5/28/24
 DATE

USCG BRIDGE PERMIT PLANS WEST DENNIS – SOUTH YARMOUTH RT 28 (MAIN STREET) BRIDGE ACROSS BASS RIVER BASS RIVER CL STA 1+66.77 RIVER MILE (1.7)	
DESCRIPTION	08/01/2020
BASS RIVER CL STA 1+66.77 DENNIS, MA – YARMOUTH MA BARNSTABLE COUNTY	DATE
CONSULTANT/AGENT	SHEET NO.
HDR	3 OF 6
APPLICANT/OWNER	
MASSDOT	

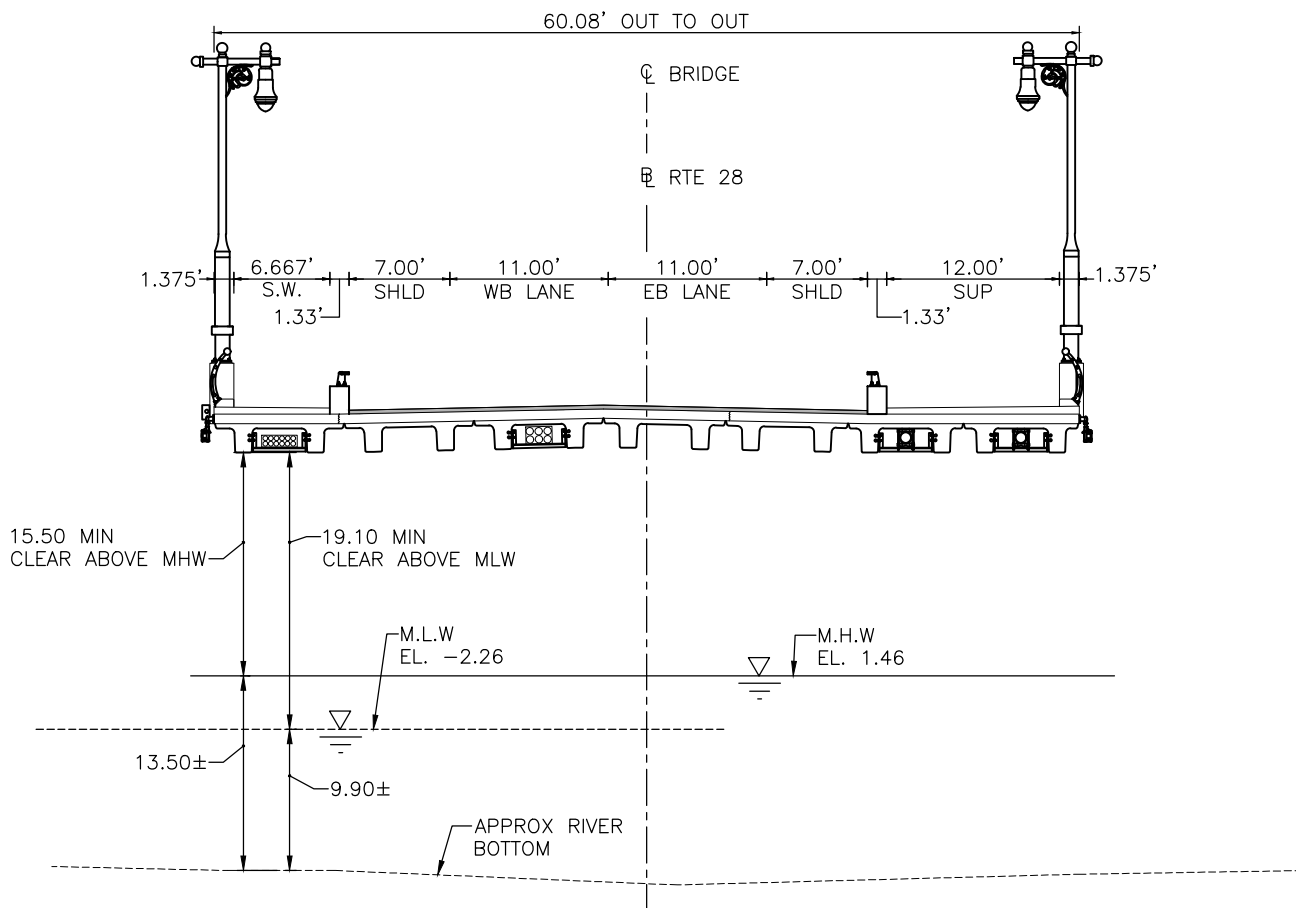
08/14 BRIDGE CAST GUARD PLAN AND ELEVATION DWG Printed on 28 May 2024
 XXXXX Structural Steel Detail (S) DD-Month-YYYY XXXXX Structural Steel Detail (S) DD-Month-YYYY



PROPOSED BRIDGE SECTION AT C CHANNEL
(LOOKING UPSTATION)

 SIGNATURE 5/28/24 DATE	USCG BRIDGE PERMIT PLANS WEST DENNIS – SOUTH YARMOUTH RT 28 (MAIN STREET) BRIDGE ACROSS BASS RIVER BASS RIVER CL STA 1+66.77 RIVER MILE (1.7)	
	DESCRIPTION BASS RIVER CL STA 1+66.77 DENNIS, MA – YARMOUTH MA BARNSTABLE COUNTY	09/01/2020 DATE SHEET NO. 4 OF 6
	CONSULTANT/AGENT HDR APPLICANT/OWNER MASSDOT	

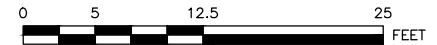
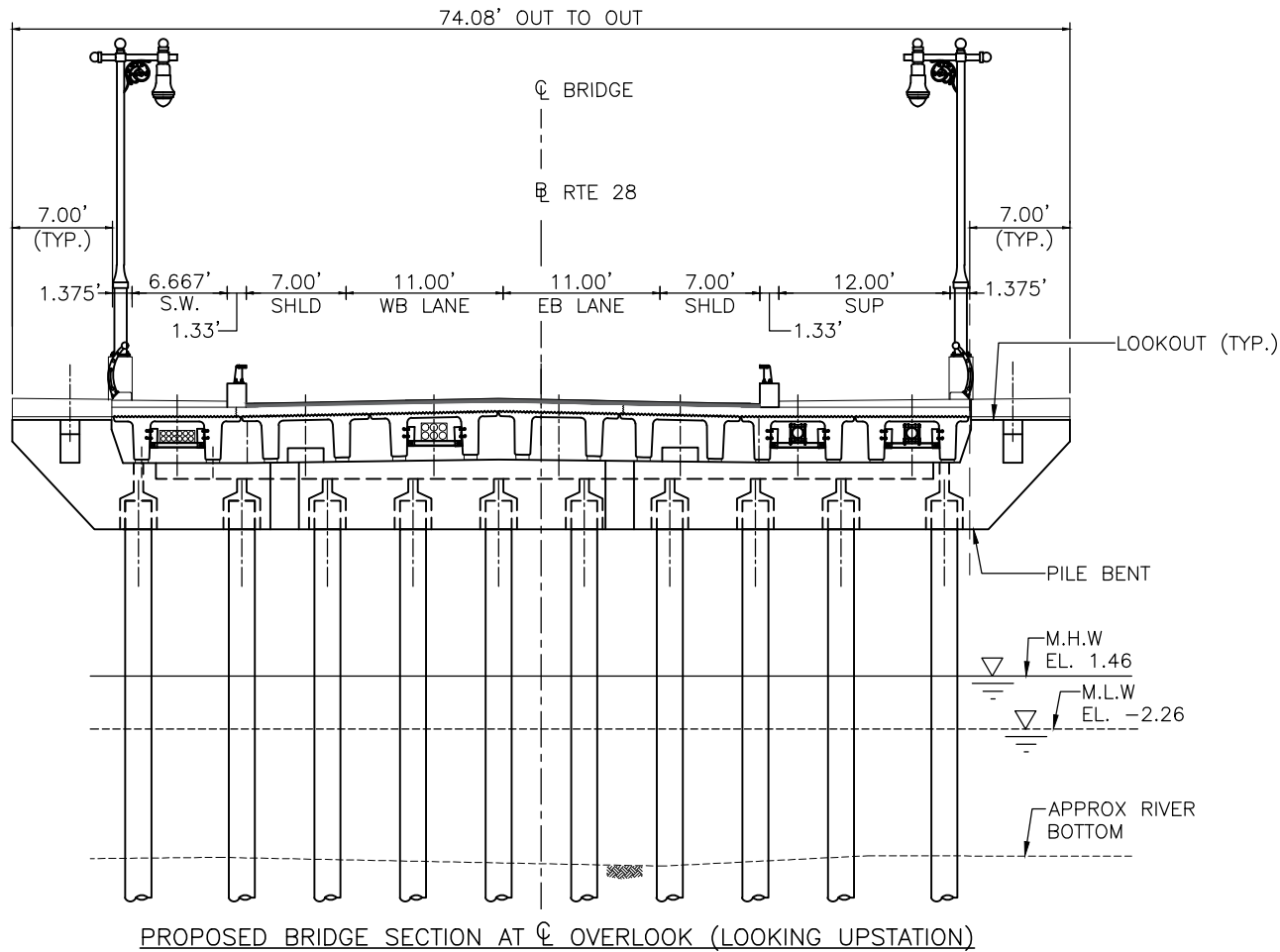

NOTES:

1. CLEAR DIMENSIONS BELOW BRIDGE ARE APPROXIMATE AND WILL DIFFER SLIGHTLY AT EACH OVERLOOK.



5/28/24
 SIGNATURE
 5/28/24
 DATE

USCG BRIDGE PERMIT PLANS
 WEST DENNIS – SOUTH YARMOUTH
 RT 28 (MAIN STREET) BRIDGE
 ACROSS BASS RIVER
 BASS RIVER CL STA 1+66.77
 RIVER MILE (1.7)

DESCRIPTION	09/01/2020
BASS RIVER CL STA 1+66.77 DENNIS, MA – YARMOUTH MA BARNSTABLE COUNTY	DATE
CONSULTANT/AGENT	SHEET NO. 5 OF 6
HDR	
APPLICANT/OWNER MASSDOT	

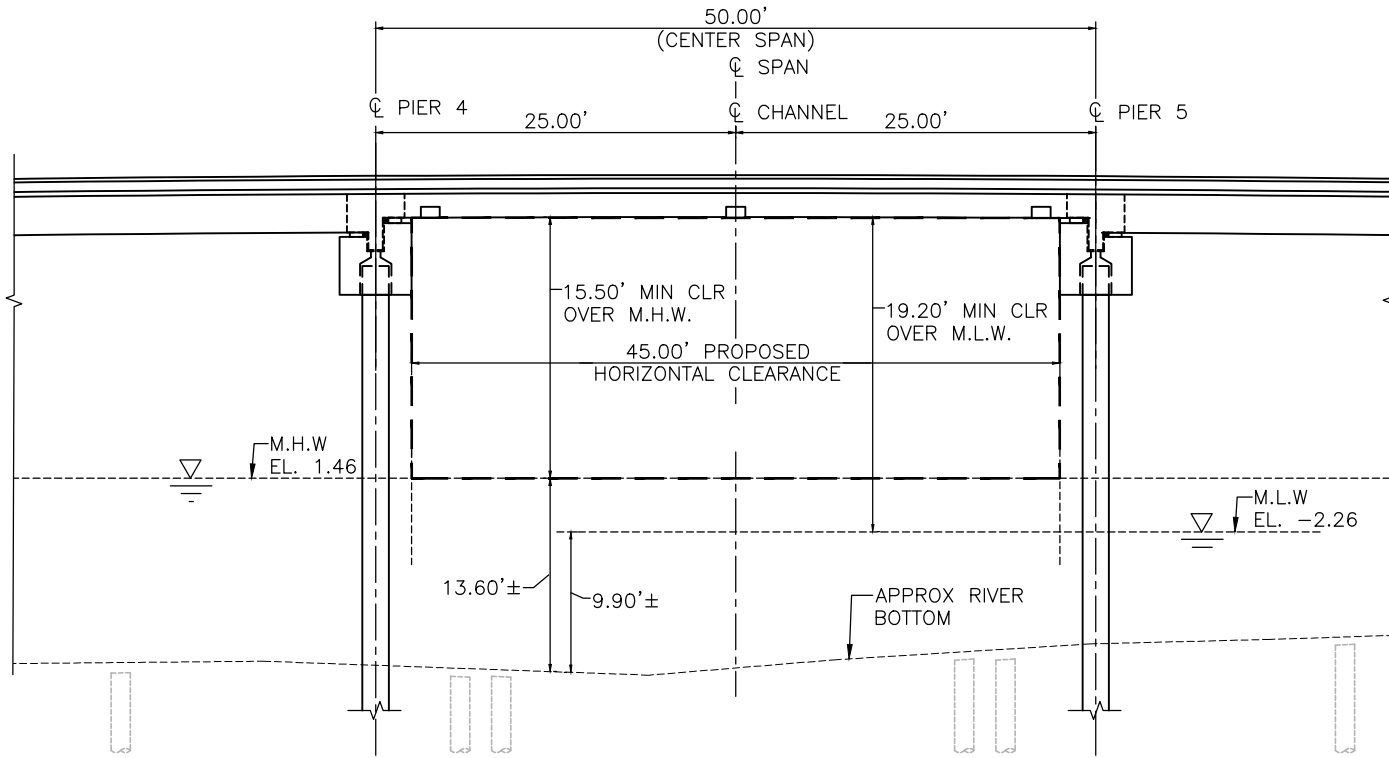

CENTER SPAN ELEVATION
(LOOKING NORTH)

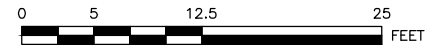

5/28/24
SIGNATURE
5/28/24
DATE

USCG BRIDGE PERMIT PLANS
WEST DENNIS – SOUTH YARMOUTH
RT 28 (MAIN STREET) BRIDGE
ACROSS BASS RIVER
BASS RIVER CL STA 1+66.77
RIVER MILE (1.7)

DESCRIPTION	09/01/2020
BASS RIVER CL STA 1+66.77	DATE
DENNIS, MA. – YARMOUTH MA BARNSTABLE COUNTY	SHEET NO.
CONSULTANT/AGENT	6 OF 6
HDR	
APPLICANT/OWNER	
MASSDOT	