



16593
March 12, 2025

PUBLIC NOTICE 1-213-2025

All interested parties are herein notified that the Commander, First Coast Guard District, has received application materials dated January 6, 2025, from the Massachusetts Department of Transportation (MassDOT) for approval of location and plans for a temporary fixed bridge across a navigable waterway of the United States.

BRIDGE, WATERWAY AND LOCATION: Temporary Hall-Whitaker Bridge (Bridge Street Bridge) across the Bass River, mile 0.6 at the City of Beverly, Essex County, Massachusetts.

CHARACTER OF WORK: Construction of a temporary roadway bridge to carry vehicle, pedestrian, and bicycle traffic which will allow MassDOT to replace the existing Hall-Whitaker Swing Bridge with a permanent bascule bridge in the current position and alignment. The temporary fixed bridge will reduce the vertical clearance for vessel traffic. The existing east bridge protective fender will be temporarily extended under the temporary bridge for safety. The temporary bridge and east fender extension is expected to be in place for five years until the new permanent drawbridge is constructed and placed in operation.

MINIMUM NAVIGATIONAL CLEARANCES:

The proposed temporary bridge will have clearances as described in the table below. In the open position the vertical clearance is limited by the National Grid System utility lines.

	Vertical	Horizontal
Existing Swing Bridge (Movable)	Open- 43.6 feet Mean High Water (upstream utility lines, not attached to bridge) Closed- 4.62 feet	Open- 40 feet
Proposed Temporary Bridge (Fixed)	6.0 feet Mean High Water	40 feet

Datum: NAVD88

ENVIRONMENTAL CONSIDERATIONS:

The Coast Guard, as the lead Federal agency for compliance with the National Environmental Policy Act, has made a tentative determination that the construction of the temporary bridge warrants a categorical exclusion. On May 7, 2024, the Massachusetts State Historic Preservation Officer concurred with the Coast Guard finding that the project would not result in adverse effects as described in Section 106 of the National Historic Preservation Act.

A water quality certification in accordance with Section 401 of the Clean Water Act, as amended, was issued by the Massachusetts Department of Environmental Protection on November 27, 2024. No wetlands will be permanently or temporarily impacted by the proposed project.

The bridge is in the floodplain. The 100-year flood elevation is 10 feet, while elevation of the low member of the navigation span is 9.73 feet. Elevations are referenced to NAVD88 datum. No discharges of fill are proposed below the high tide line of the Bass River.

The project complies with the requirements of the Coastal Zone Management Act, the Endangered Species Act, the Marine Mammal Protection Act, the Migratory Bird Treaty Act and the Bald and Golden Eagle Act.

SOLICITATION OF COMMENTS:

Mariners are requested to comment on the proposed navigation clearances, placement of a bridge protective system and other navigational safety issues, including the need for clearance gauges and extent of nighttime navigation to determine the need for bridge lighting.

Interested parties are requested to express their views, in writing, on the proposed bridge project including its possible environmental impacts giving sufficient detail to establish a clear understanding of the reasons for support of, or opposition to, the proposed work. Comments will be received for the record at the address noted in the header or via email SMB-D1Boston-Bridges-PublicNotices@uscg.mil through March 28, 2025. A 15-day comment period is provided due to the extensive outreach already conducted by MassDOT to the local boating community.

Map of location and plans attached.

G. P. Hitchen
Bridge Program Manager
U. S. Coast Guard
By direction

CONCEPTUAL PLANS UTILIZED TO OBTAIN COAST GUARD PERMIT

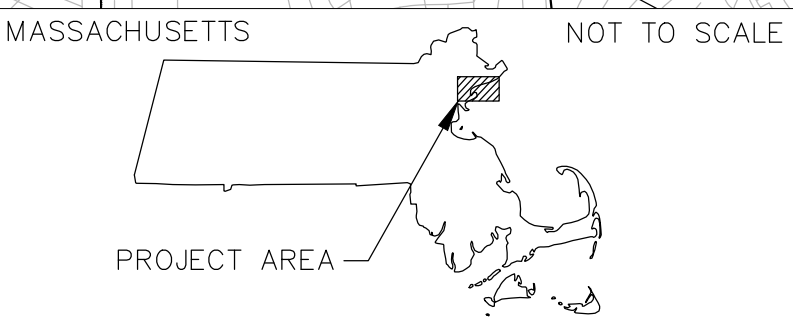
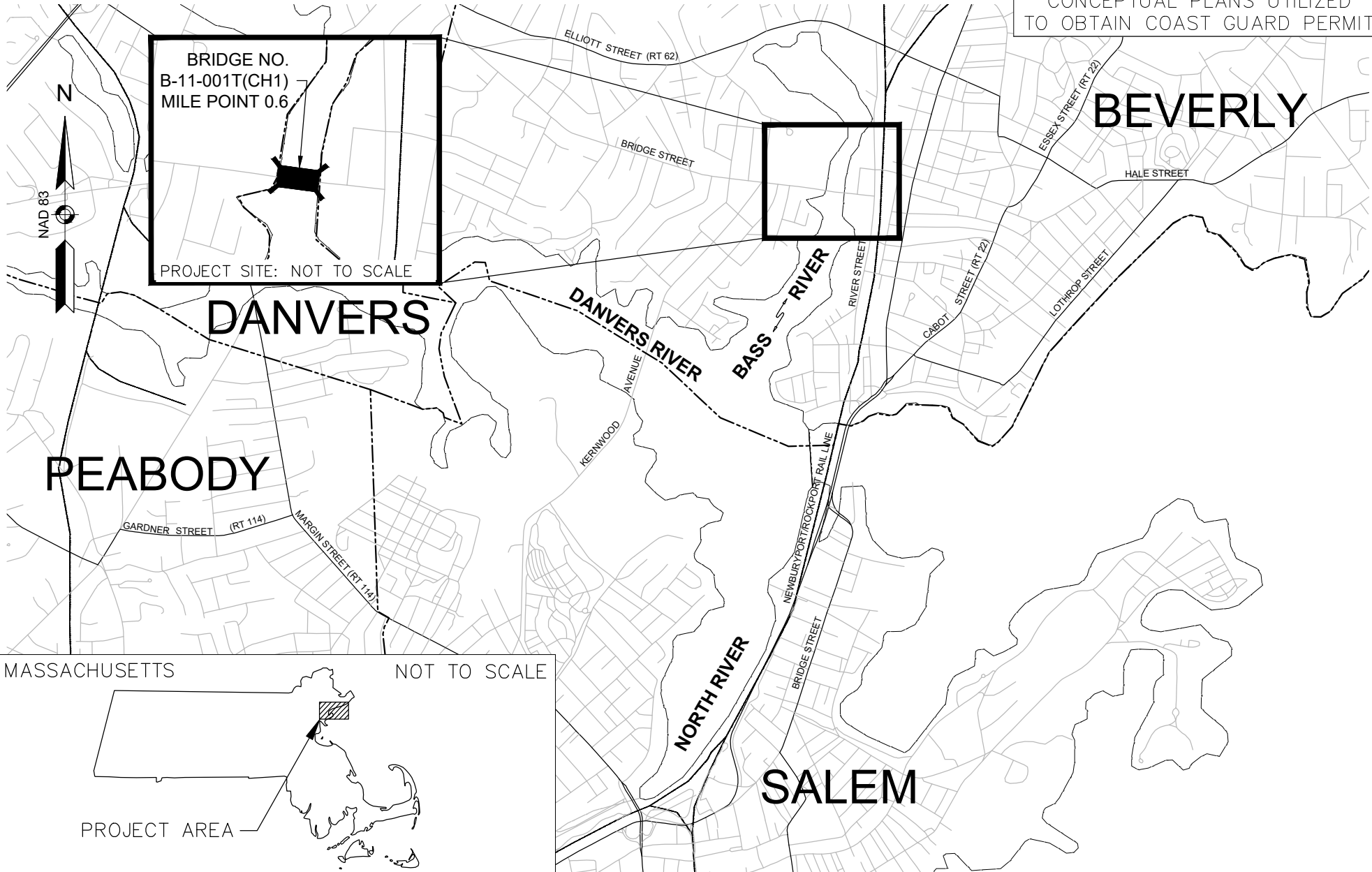

MARCH 6, 2025
SHEET 1 OF 5

MASSACHUSETTS DEPARTMENT OF TRANSPORTATION (MASSDOT)
 BRIDGE NO. B-11-001T(CH1) HALL-WHITAKER TEMPORARY BRIDGE
 BASS RIVER M.P. 0.6
 BEVERLY, ESSEX COUNTY, MASSACHUSETTS
 LOCATION/VICINITY MAP

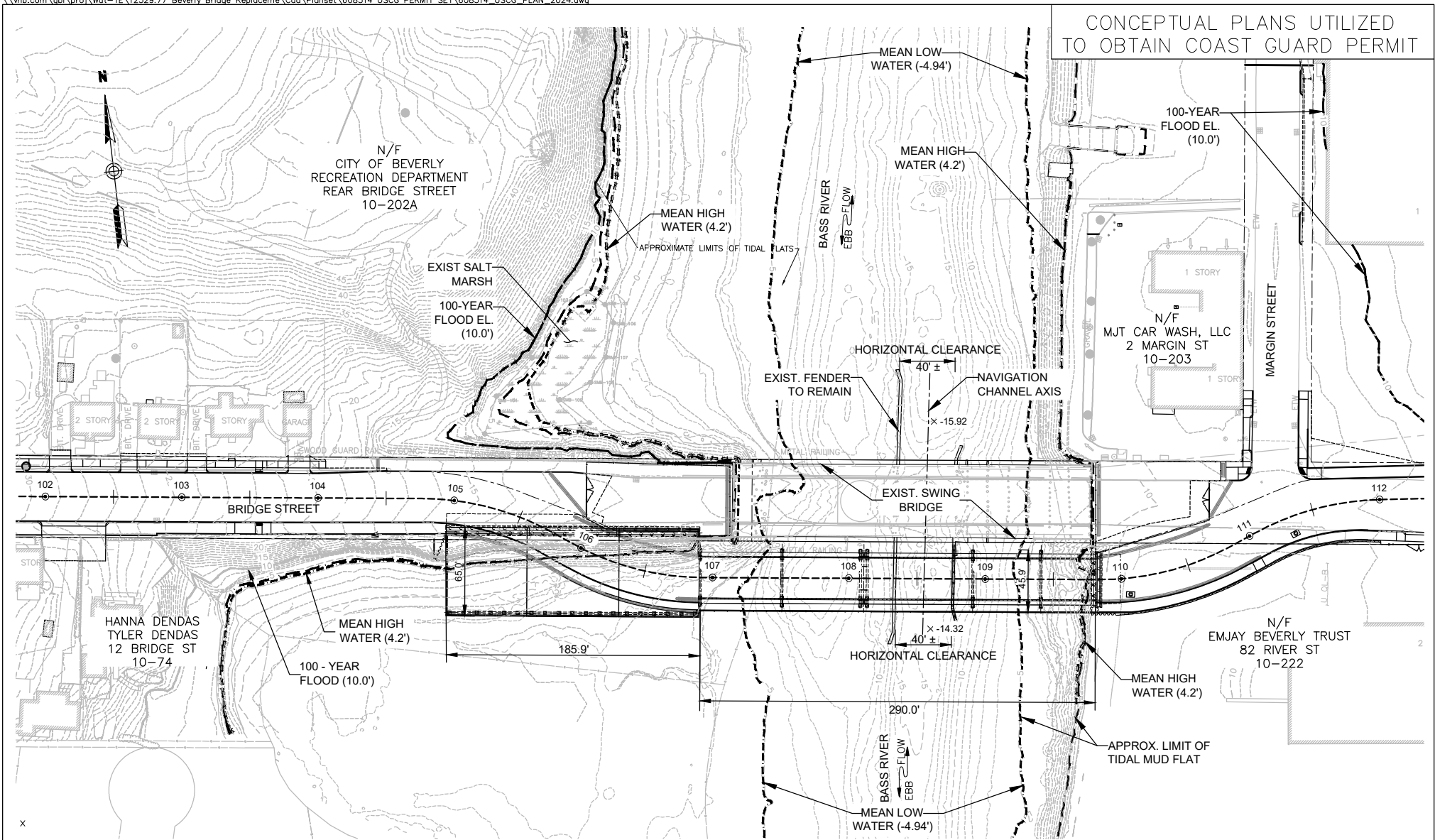

CONCEPTUAL PLANS UTILIZED TO OBTAIN COAST GUARD PERMIT

PLAN
SCALE 1"=100'

- NOTES:
1. VERTICAL DATUM IS BASED ON NORTH AMERICAN 1988: NAVD88
 2. HYDROGRAPHIC ELEVATIONS SOURCE: HYDRAULIC REPORT-VHB, MAY, 2024
 3. EXISTING SWING BRIDGE TO BE REMOVED IN ITS ENTIRETY.



MARCH 6, 2025
SHEET 2 OF 5

MASSACHUSETTS DEPARTMENT OF TRANSPORTATION (MASSDOT)
BRIDGE NO. B-11-001T(CH1) HALL-WHITAKER TEMPORARY BRIDGE
BASS RIVER M.P. 0.6
BEVERLY, ESSEX COUNTY, MASSACHUSETTS
PLAN VIEW

CONCEPTUAL PLANS UTILIZED
TO OBTAIN COAST GUARD PERMIT

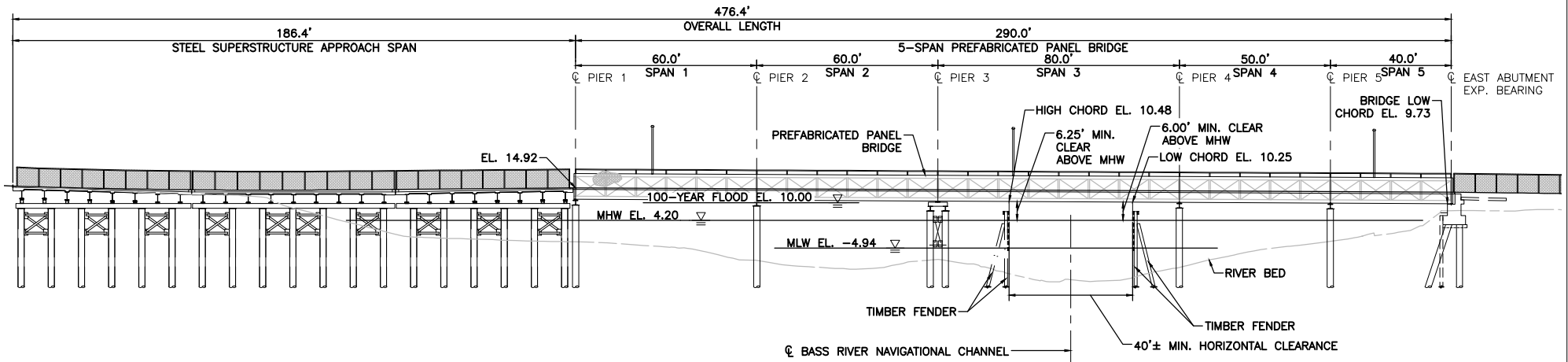

SOUTH ELEVATION
SCALE 1"=50'

- NOTES:
1. VERTICAL DATUM IS BASED ON NORTH AMERICAN 1988: NAVD88
 2. HYDROGRAPHIC ELEVATIONS SOURCE: HYDRAULIC REPORT - VHB, MAY, 2024

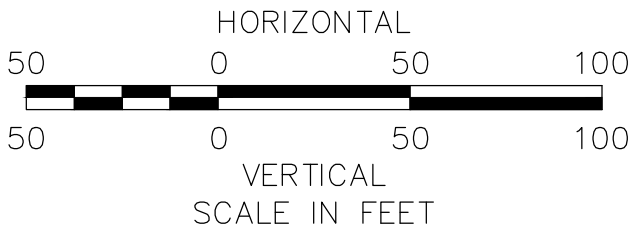

MARCH 6, 2025
SHEET 3 OF 5

MASSACHUSETTS DEPARTMENT OF TRANSPORTATION (MASSDOT)
BRIDGE NO. B-11-001T(CH1) HALL-WHITAKER TEMPORARY BRIDGE
BASS RIVER M.P. 0.6
BEVERLY, ESSEX COUNTY, MASSACHUSETTS
ELEVATION VIEW

CONCEPTUAL PLANS UTILIZED TO OBTAIN COAST GUARD PERMIT

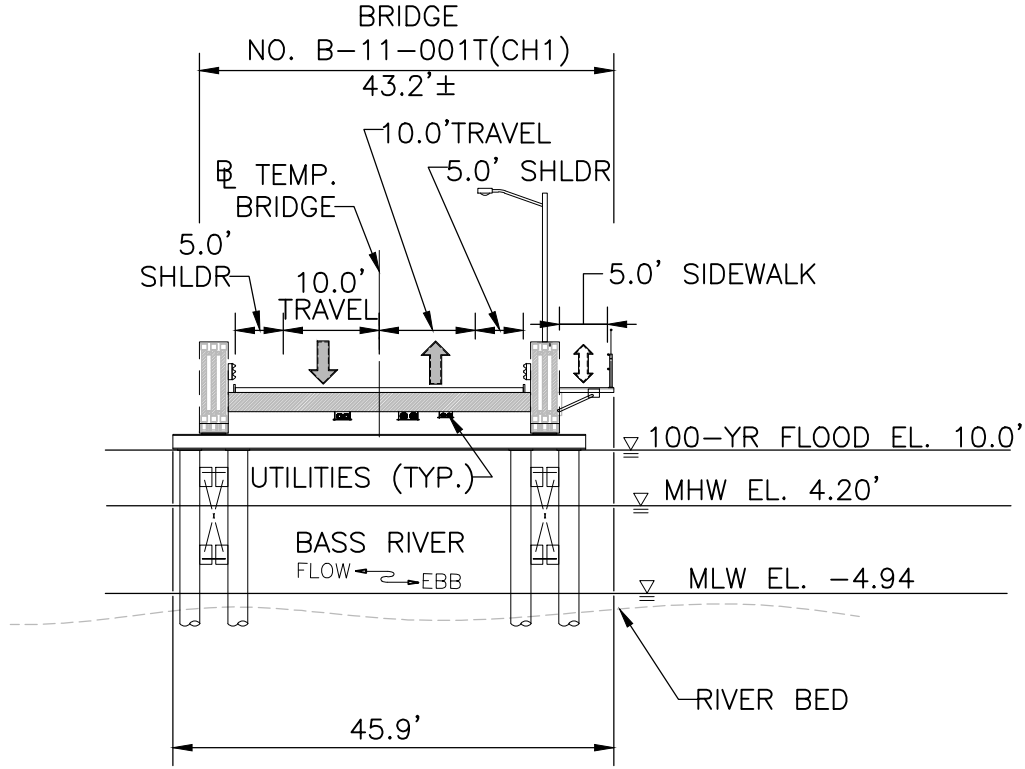

TYPICAL SECTION
SCALE 1"=20'

- NOTES:
1. VERTICAL DATUM IS BASED ON NORTH AMERICAN 1988: NAVD88
 2. HYDROGRAPHIC ELEVATIONS SOURCE: HYDRAULIC REPORT - VHB, MAY, 2024

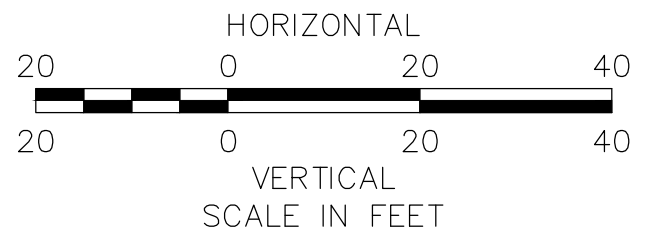

MARCH 6, 2025
SHEET 4 OF 5

MASSACHUSETTS DEPARTMENT OF TRANSPORTATION (MASSDOT)
BRIDGE NO. B-11-001T(CH1) HALL-WHITAKER TEMPORARY BRIDGE
BASS RIVER M.P. 0.6
BEVERLY, ESSEX COUNTY, MASSACHUSETTS
TYPICAL SECTION VIEW

CONCEPTUAL PLANS UTILIZED
TO OBTAIN COAST GUARD PERMIT

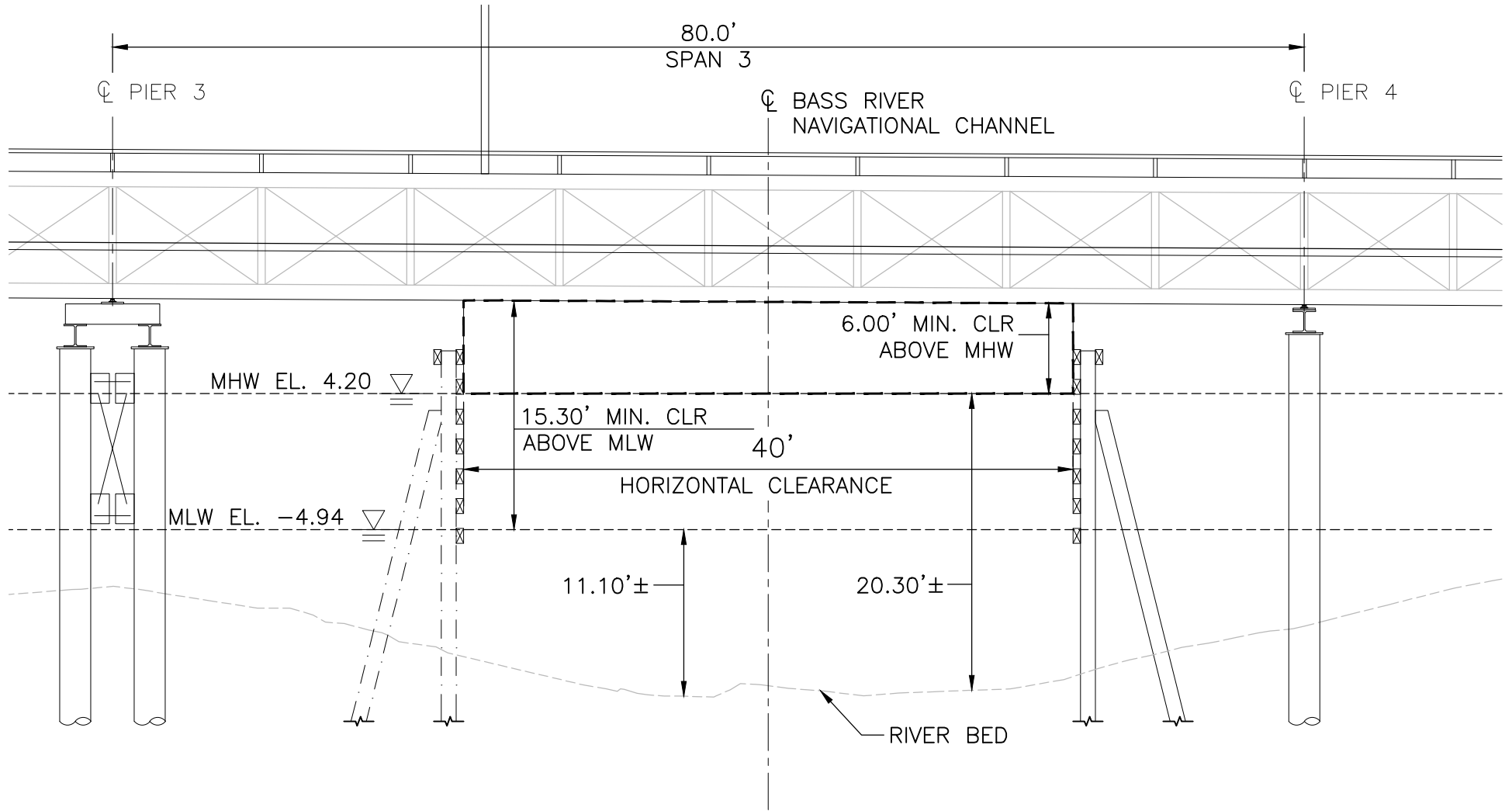

CENTER SPAN ELEVATION
SCALE 1"=50'

- NOTES:
1. VERTICAL DATUM IS BASED ON NORTH AMERICAN 1988: NAVD88
2. HYDROGRAPHIC ELEVATIONS SOURCE: HYDRAULIC REPORT - VHB, MAY, 2024

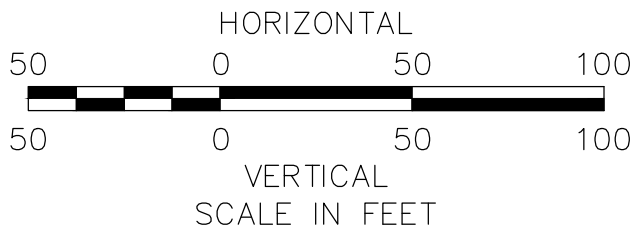

MARCH 6, 2025
SHEET 5 OF 5

MASSACHUSETTS DEPARTMENT OF TRANSPORTATION (MASSDOT)
BRIDGE NO. B-11-001T(CH1) HALL-WHITAKER TEMPORARY BRIDGE
BASS RIVER M.P. 0.6
BEVERLY, ESSEX COUNTY, MASSACHUSETTS
CENTER SPAN ELEVATION VIEW