



16591/3934
December 29, 2020

PUBLIC NOTICE (08-20)

All interested parties are notified that the Commander, Seventh Coast Guard District has received an application from Monroe County, Florida requesting approval of the location and plans for the construction of a bridge over a navigable waterway of the United States.

WATERWAY AND LOCATION: Joe's Canal, mile 0.0 at Duck Key, Monroe County, FL at Latitude 24°46'08.48"N, Longitude 80°55'14.22"W (24.769003, -80.920617). The bridge is known as Harbour Drive Bridge.

CHARACTER OF WORK: The existing Harbour Drive Bridge has been deemed structurally deficient with weight restrictions placed upon it. Monroe County proposes replacing the existing fixed-span Harbour Drive Bridge crossing Joe's Canal along the same alignment. The typical section of the replacement bridge includes two (2) 11-foot travel lanes, 2.5-foot wide shoulders, a 5-foot wide sidewalk on the eastern side of the bridge, and decorative railings. The sidewalk will be separated from the travel lanes by the 2.5-foot shoulder. The overall length of the proposed bridge will be approximately 64.5 ft. and the out-to-out width will be approximately 34.67 ft.

MINIMUM NAVIGATIONAL CLEARANCES:

Existing

Horizontal:

46.58 ft. between face of piles

Vertical:

14.87 ft. above Mean High Water

15.35 ft. above Mean Low Water

Proposed

Horizontal:

46.58 ft. between face of piles

Vertical:

14.87 ft. above Mean High Water

15.35 ft. above Mean Low Water

North American Vertical Datum of 1988 (NAVD 88) (Existing and Proposed bridges)

ENVIRONMENTAL CONSIDERATIONS: The United States Coast Guard (USCG) is the lead federal agency for compliance with the National Environmental Policy Act (NEPA), National Historic Preservation Act (NHPA), and other applicable environmental control laws. The USCG has made a tentative determination that the proposed project is a categorical exclusion for the purposes of NEPA because it satisfies criteria for such actions listed in the Coast Guard's NEPA Implementing Instructions. The documents are available for review at the above address, Monday through Friday, 8:00 a.m. to 4:00 p.m.

The bridge is located in the floodplain. The 100-year flood elevation is 5.7 feet above datum and the bridge low member elevation is approximately 13.09 feet. The South Florida Water

Management District (SFWMD) is the certifying agency, as defined in 40 CFR § 121.1(e), for issuance of Water Quality Certification (WQC) pursuant to Section 401, Public Law 92-500, 33 U.S.C. Section 1341. The SFWMD issued a general Environmental Resource Permit (ERP) # 44-104295-P, dated 20 November 2020, which constitutes WQC.

In coordination with the National Marine Fisheries Service and Florida Keys National Marine Sanctuary (FKNMS), the Coast Guard determined that impacts to threatened and endangered species, pursuant to the Endangered Species Act (ESA), and impacts to Essential Fish Habitat (EFH), pursuant to the Magnuson-Stevens Act, under the purview of NMFS, are de minimis. The Coast Guard is in consultation with NOAA in respect to the ESA, and no further consultation is required for the EFH unless the scope of the project changes. The FKNMS reviewed the project and issued a letter of authorization dated November 19, 2020 under #FKNMS-2020-146 for the bridge replacement and associated work within the sanctuary. Based on applicant/consultant collected field data and in-house reviews, there are no wetlands and one (1) surface water within the project area. Impacts directly attributable to the proposed bridge and reconstructing the eroded canal walls total 0.001 acres of surface water habitat.

The USCG, in consultation with the Florida State Historic Preservation Officer (SHPO) and Monroe County, has determined that the project requires removal of a National Register of Historic Places eligible historic bridge (Harbour Drive Bridge) which will have an adverse effect on the resource. Taking into account the effects of the undertaking on historic properties, the USCG, SHPO, and Monroe County have executed a Memorandum of Agreement (MOA), dated 17 Oct 2018, pursuant to Section 106 of the National Historic Preservation Act of 1966.

REMOVAL OF EXISTING BRIDGE: All parts of the existing to be replaced bridge, not utilized for the new bridge, shall be removed in their entirety.

ANTICIPATED IMPACTS TO NAVIGATION DURING CONSTRUCTION: Anticipated impacts to navigation during construction include use of construction barges within the waterway. Mariners will be notified of the details of in-water construction activities which may impact navigation at and around the bridge site. Details of any such impacts will be disseminated to mariners via the Coast Guard's Local Notice to Mariners (LNM). To subscribe to the Coast Guard LNM and other free Coast Guard navigation notification services, please visit <http://www.navcen.uscg.gov/> under "Subscribe / Report (free)" select the notifications you wish to receive; note this project is located in the Seventh Coast Guard District area.

ENVIRONMENTAL DISCLAIMER: The foregoing does not necessarily include information related to environmental control laws or Executive Orders in which there are no known adverse impacts. Therefore, comments are requested on any environmental control law or Executive order, with known adverse impacts, that has not been addressed or adequately addressed in this notice.

SOLICITATION OF COMMENTS: Mariners are requested to comment on the proposed vertical and horizontal navigational clearances and other navigational safety issues including, but not limited to, the extent of nighttime navigation, need for bridge fendering, and impacts due to construction activities.

Interested parties are requested to express their views, in writing, on the proposed bridge project including its possible impact on minority and/or low income population, if any, giving sufficient

detail to establish a clear understanding of their reasons for support of, or opposition to, the proposed work. Comments will be received for the record at the office of: Commander (dpb), Seventh Coast Guard District, 909 SE 1st Ave., Ste 432, Miami, Florida 33131-3028, for a 30-day period from the date of this public notice. The project manager for this application is Mr. Marty Bridges. He can be contacted by telephone at (305) 415-6766, by mail at the above address, or email at martin.a.bridges@uscg.mil. Comments received will be made part of the case record. Map of location and plans attached.

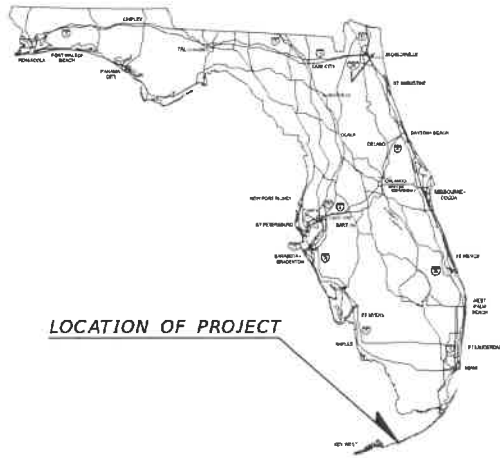
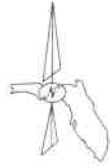

LOCATION OF PROJECT

END BRIDGE
STA. 12+46.25

TO LAYTON

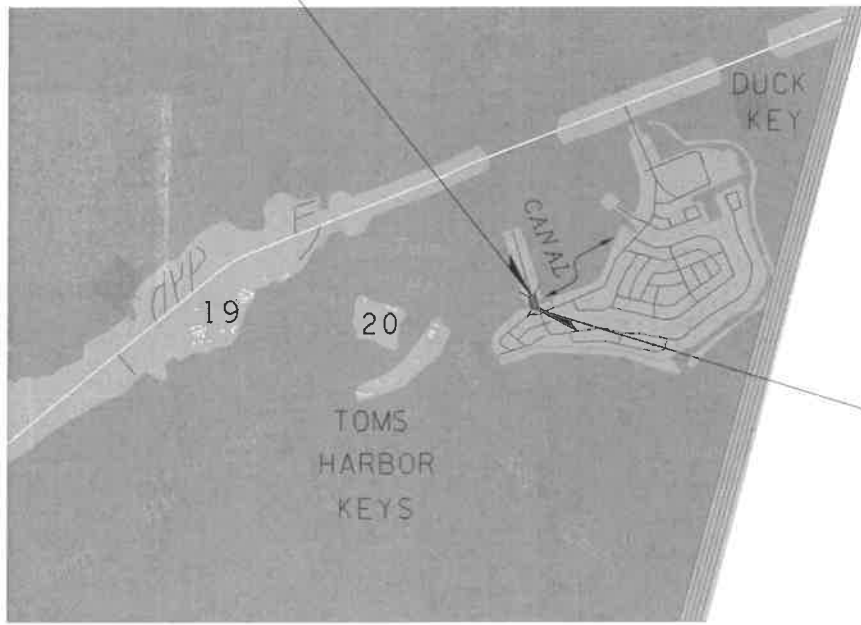

BEGIN BRIDGE
STA. 11+81.75

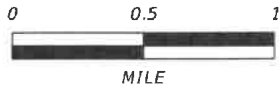

CONCEPTUAL PLANS UTILIZED TO
OBTAIN COAST GUARD BRIDGE
PERMIT

APPLICANT: Monroe County
CONSULTANT: Kisinger Campo & Associates
BRIDGE NAME: Harbour Drive
WATERWAY NAME: Joe's Canal
WATERWAY MILE POINT: 0.00
LOCATION: Duck Key, Monroe County, Florida
PLANS DATE: July 24, 2020

AUSTIN BLACK, P.E.
P.E. LICENSE NUMBER 83487
KISINGER CAMPO AND ASSOCIATES
201 N. FRANKLIN STREET SUITE 400
TAMPA, FL 33602
CERTIFICATE OF AUTHORIZATION: 02317



MONROE COUNTY ENGINEERING
SERVICES DEPARTMENT
1100 SIMONTON STREET
KEY WEST, FLORIDA 33040

LOCATION MAP

HARBOUR BRIDGE REPLACEMENT	SHEET NO. 1 OF 4
----------------------------	---------------------

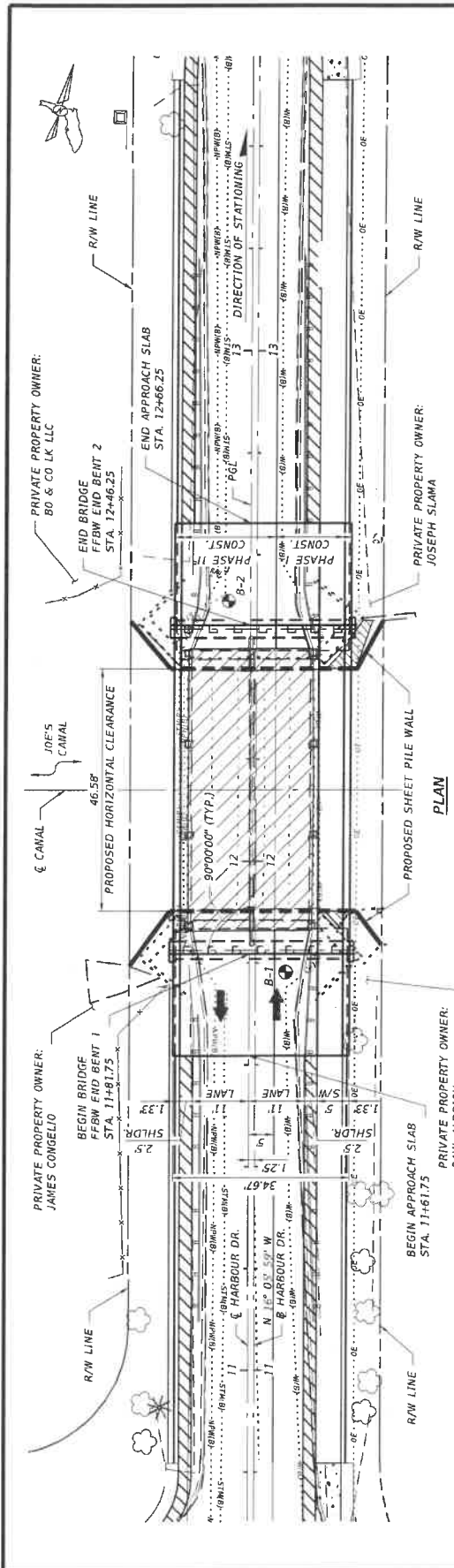

LEGEND:

- EXISTING BRIDGE NO. 904604 TO BE REMOVED
- FILL BEHIND SHEET PILE WALL
TOTAL FILL = 42.75 SF
TOTAL FILL = 4 CY
(1.3 CY FILL BELOW MHW)

CONCEPTUAL PLANS UTILIZED TO OBTAIN
COAST GUARD BRIDGE PERMIT

APPLICANT: Monroe County
 CONSULTANT: Kirsinger Campo & Associates
 BRIDGE NAME: Harbour Drive
 WATERWAY NAME: Joe's Canal
 WATERWAY MILE POINT: 0.000
 OCCUR: Duck Key, Monroe County, Florida
 PLANS DATE: July 24, 2020

DATE	BY	FOR
07/20	AT	ENGINEER OF RECORD
07/20	AT	ASSISTING CIVIL
07/20	AT	2019 F. F. F. F. F. F.
07/20	AT	2019 F. F. F. F. F. F.
07/20	AT	2019 F. F. F. F. F. F.
07/20	AT	2019 F. F. F. F. F. F.
07/20	AT	2019 F. F. F. F. F. F.
07/20	AT	2019 F. F. F. F. F. F.
07/20	AT	2019 F. F. F. F. F. F.
07/20	AT	2019 F. F. F. F. F. F.

MONROE COUNTY
ENGINEERING SERVICES DEPARTMENT
 1100 S. MONROE ST. ROOM 2-218
 P.O. BOX 13001
 MONROE, FLORIDA 33400
 TEL: 813.937.4456
 FAX: 813.937.4456

BRIDGE NO. 904614

PLAN AND ELEVATION

HARBOUR DRIVE
BRIDGE REPLACEMENT

SHEET NO. **2** OF **2**

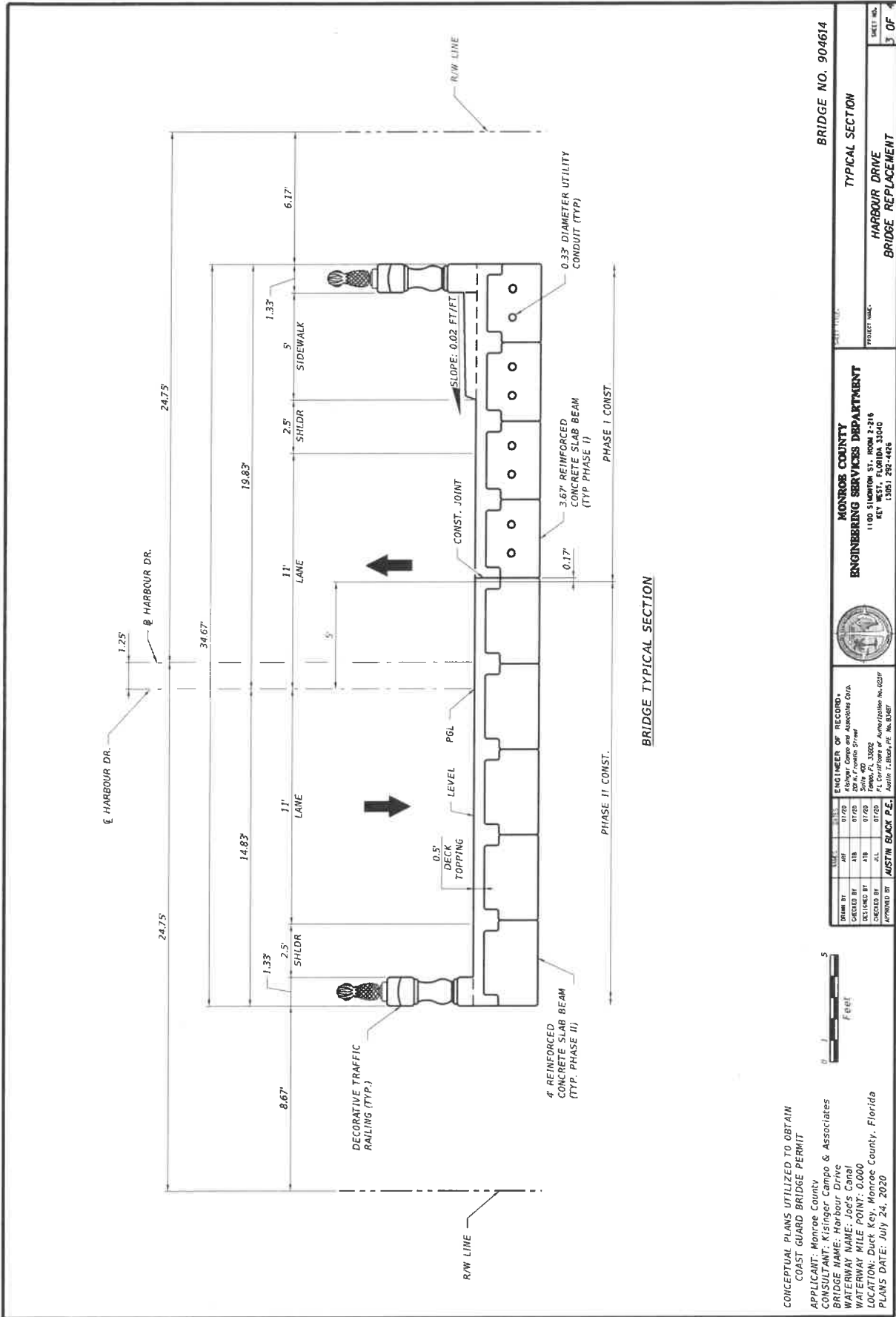

BRIDGE TYPICAL SECTION

CONCEPTUAL PLANS UTILIZED TO OBTAIN
 COAST GUARD BRIDGE PERMIT
 APPLICANT: Monroe County
 CONSULTANT: Kisinger Campo & Associates
 BRIDGE NAME: Harbour Drive
 WATERWAY NAME: Joe's Canal
 LOCATION: Duck Key, Monroe County, Florida
 PLANS DATE: July 24, 2020



DATE	BY	REVISION
07/20	AM	07/20
07/20	AM	07/20
07/20	AM	07/20
07/20	AM	07/20
07/20	AM	07/20

ENGINEER OF RECORD:
 Kisinger Campo & Associates, OIA
 1100 S. WEST 15TH AVE. SUITE 400
 WEST PALM BEACH, FL 33411
 AUSTIN T. BLACK, P.E. No. 61487



MONROE COUNTY
 ENGINEERING SERVICES DEPARTMENT
 1100 S. WEST 15TH AVE. SUITE 2-216
 WEST PALM BEACH, FL 33411
 1.305.1.292.4436

TYPICAL SECTION
 HARBOUR DRIVE
 BRIDGE REPLACEMENT

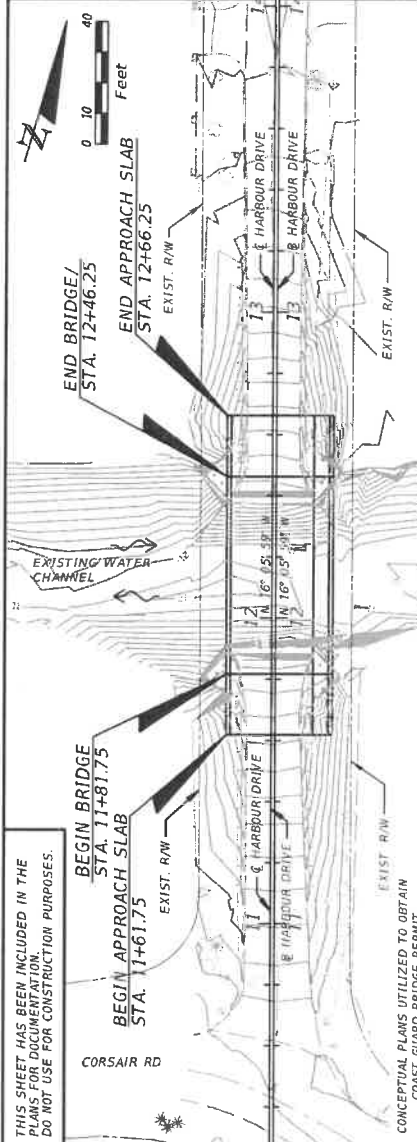
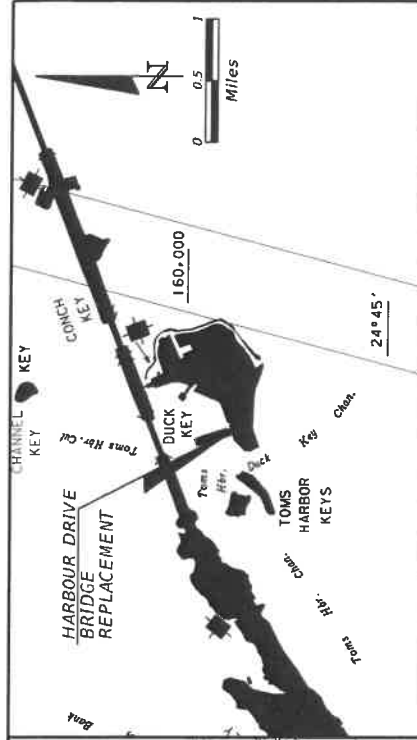

(REFERENCE)	EXISTING STRUCTURES	PROPOSED STRUCTURE
1. J. J. N.	1. 2. (3) (4)	1. 5' CONC. PILES
2. S. 6. 7.		2. 64" DIA.
3. P.C.E.-CAST CONC. ARCH		3. 250 SF
4. AREA OF OPENING: 250 SF		4. 250 SF
5. BRIDGE WIDTH: 25'		5. 25'
6. ELEV. LOW MEMBER: 14.28' NAVD.		6. 14.28' NAVD.

HYDRAULIC DESIGN DATA	
NOTE:	The hydraulic data is shown for informational purposes only to indicate the flood discharges and water surface elevations which may be anticipated in any given year. This data was developed based on the design flow determined by a study of the watershed. Many judgments and assumptions are required to establish these factors. The resultant hydraulic data is sensitive to changes, particularly antecedent conditions, urbanization, channelization and land use. Users of this data are cautioned against the assumption of precision which cannot be obtained.
TERMS:	Base Flood: Utilized to assure a desired level of hydraulic performance. Overtopping Flood: Has a 1% chance of being exceeded in any given year (100 year frequency) Flood: The most severe that can be predicted where overtopping is not practicable.
WATER SURFACE ELEVATIONS:	M.H.W. (NON-TIDAL) MA M.H.W. (TIDAL) -0.61' NAVD N.L.W. (TIDAL) -1.09'
FLOOD DATA:	MAX. ELEV. OF RECORD DESIGN FLOOD BASE FLOOD STAGE ELEV. NAVD (ft) MA MA MA AVERAGE VELOCITY (ft/s) 3.20 5.87 5.87 EXCEEDANCE PROB. (%) MA MA MA FREQUENCY (yr.) MA MA MA
SCOUR PREDICTIONS FOR PROPOSED STRUCTURE DESCRIBED ABOVE:	LONG TERM SCOUR ELEVATION WORST CASE < 100 YR. MA FREQ. (YR.) MA

HYDRAULIC RECOMMENDATIONS	
1. BEGIN BRIDGE STATION:	11+81.75
2. CLEARANCE PROVIDED: NAV. HORIZ. MA.	51.25' VERT. 14.11' HORIZ. DRIFT HORZ. 51.25' VERT. 14.11' HORIZ. DRIFT HORZ. 10' VERT. 14.11' HORIZ. DRIFT HORZ. 10'
3. MINIMUM CLEARANCE: NAV. HORIZ. MA.	ABOVE EL. -0.61' NAVD. DRIFT HORZ. 10' VERT. 14.11' HORIZ. DRIFT HORZ. 10'
4. ABUTMENTS:	END BRIDGE
RIBBLE GRADE:	STEEL SHEETPILE WALL
TOE HORIZ. DISTANCE:	MA
LIMIT OF PROTECTION:	MA
DECK DRAINAGE:	NO SCUPPERS

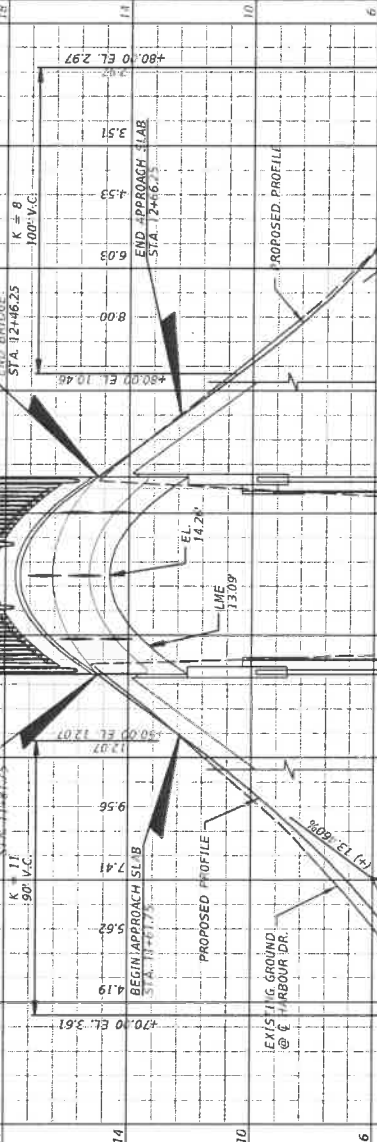

HYDRAULIC RECOMMENDATIONS	
1. BEGIN BRIDGE STATION:	11+81.75
2. CLEARANCE PROVIDED: NAV. HORIZ. MA.	51.25' VERT. 14.11' HORIZ. DRIFT HORZ. 51.25' VERT. 14.11' HORIZ. DRIFT HORZ. 10' VERT. 14.11' HORIZ. DRIFT HORZ. 10'
3. MINIMUM CLEARANCE: NAV. HORIZ. MA.	ABOVE EL. -0.61' NAVD. DRIFT HORZ. 10' VERT. 14.11' HORIZ. DRIFT HORZ. 10'
4. ABUTMENTS:	END BRIDGE
RIBBLE GRADE:	STEEL SHEETPILE WALL
TOE HORIZ. DISTANCE:	MA
LIMIT OF PROTECTION:	MA
DECK DRAINAGE:	NO SCUPPERS

HYDRAULIC RECOMMENDATIONS	
1. BEGIN BRIDGE STATION:	11+81.75
2. CLEARANCE PROVIDED: NAV. HORIZ. MA.	51.25' VERT. 14.11' HORIZ. DRIFT HORZ. 51.25' VERT. 14.11' HORIZ. DRIFT HORZ. 10' VERT. 14.11' HORIZ. DRIFT HORZ. 10'
3. MINIMUM CLEARANCE: NAV. HORIZ. MA.	ABOVE EL. -0.61' NAVD. DRIFT HORZ. 10' VERT. 14.11' HORIZ. DRIFT HORZ. 10'
4. ABUTMENTS:	END BRIDGE
RIBBLE GRADE:	STEEL SHEETPILE WALL
TOE HORIZ. DISTANCE:	MA
LIMIT OF PROTECTION:	MA
DECK DRAINAGE:	NO SCUPPERS

REMARKS: WAVE CRASH ELEVATION = 47.1' FT NAVD
 ALL ELEVATIONS ARE IN FEET AND REFERENCED TO NAVD 88 AND DO NOT INCLUDE SEA LEVEL RISE.

BRIDGE HYDRAULIC RECOMMENDATIONS SHEET

INTERA Incorporated
 2114 NW 40th Terrace, Suite A-1
 Gainesville, FL 32605
 Florida Certificate of Authorization No. 9052
 Engineer of Record: Philip E. Domeje
 P.E. No.: 54571

MONROE COUNTY
 ENGINEERING SERVICES DEPARTMENT

BRIDGE NO. 904614

DATE: _____ DESCRIPTION: _____

REVISIONS: _____

DATE: _____ DESCRIPTION: _____

DATE: _____ DESCRIPTION: _____

DATE: _____ DESCRIPTION: _____