



29 Dec 2022

PUBLIC NOTICE 01-23

All interested parties are notified that the Commander, Thirteenth Coast Guard District, has received application materials dated 28 July 2021 from the Oregon State Department of Transportation (ODOT) for approval of the location and plans for the replacement of a bridge over a navigable waterway of the United States.

WATERWAY AND LOCATION: Willamette River, at river mile 132.1, between the City of Corvallis, Benton County, and Linn County, Oregon.

CHARACTER OF WORK: The existing Van Buren Bridge is a 4-span, steel truss roadway bridge with a pin-connected swing span, constructed in 1913. It includes a separated 6-foot-wide pedestrian path on its south side.

The swing span portion consists of two 114-foot trusses with a 21-foot-wide pier that housed the turntable machinery. The swing span has not opened since 1960. The bridge carries one lane of eastbound vehicular traffic out of Corvallis, across the Willamette River and onto Oregon Highway 34, which is the main highway connecting Corvallis to Interstate 5 (I-5).

ODOT proposes to remove the existing bridge and replace it with a new fixed, two-lane eastbound motor vehicle bridge with a separated bike lane and multi-use pedestrian path. The project purpose is to provide a seismically resilient bridge that provides increased vehicle capacity, meets modern design standards, and maintains access for emergency, commercial, freight, and multi-modal transportation.

To provide transportation and access to the work site during construction, two temporary structures are proposed: a temporary detour bridge and a temporary work bridge.

MINIMUM CLEARANCES AT CENTER OF NAVIGATION CHANNEL (OHW*)

The proposed new permanent bridge and temporary bridges will have clearances in feet above OHW as shown in the table below. The clearances for the permanent bridge will be an increase from existing clearances.

Navigational Clearances	Existing Bridge	Proposed New Bridge	Temp Detour Bridge	Temp Work Bridge
Vertical	25.2	32.9	18.4	17.4
Horizontal	110	167.0	40.0	40

*Ordinary High Water = elevation: 206.1' (NAVD 88)

ENVIRONMENTAL CONSIDERATIONS:

The Federal Highway Administration (FHWA) is the Lead Federal Agency (LFA) for satisfying the requirements of the National Environmental Policy Act (NEPA), as amended. FHWA is acting on behalf of the Coast Guard for all environmental control laws. FHWA is expected to prepare a Categorical Exclusion (CE), pursuant to NEPA. The Coast Guard has tentatively determined that the proposed action will not have a significant impact for purposes of NEPA and expects to issue a Coast Guard CE for the project. Available environmental documents are available for review at: <https://www.oregon.gov/odot/projects/pages/project-details.aspx?project=20688>

A water quality certification in accordance with Section 401 of the Clean Water Act, as amended, for this project is expected to be programmatically covered under provisions of the U.S. Corps of Engineer's Nationwide Permit #14 (Linear transportation project). The project is located in the 100-year floodplain but is not expected to result in an increase to the 100-year flood elevation of 223.5 feet. The low steel elevation of the proposed bridge is 239.0 feet. No wetlands will be taken or affected by this project.

The decision as to whether to grant approval of the location and plans for the proposed action rests primarily upon the effect it has on navigation.

SOLICITATION OF COMMENTS:

All interested parties are requested to comment on the proposed navigation clearances, placement of bridge protective system and other navigational safety issues, including the need for clearances gauges and extent of nighttime navigation to determine the need for bridge lighting. Interested parties are requested to express their views in writing, on the proposed bridge and its possible impacts on navigation or the environment.

We will forward comments of an environmental nature, such as those regarding wildlife refuges, endangered species, public parks, historic sites, wetlands, floodplain issues, air, water quality, environmental justice, etc. to the FHWA. Comments will be received for the record at the address in the header or via email at: D13-SMB-D13-BRIDGES@uscg.mil through 4 February 2023.

Map of location and plans attached.

STEVEN M. FISCHER



Bridge Administrator
by direction of the Commander
13th Coast Guard District

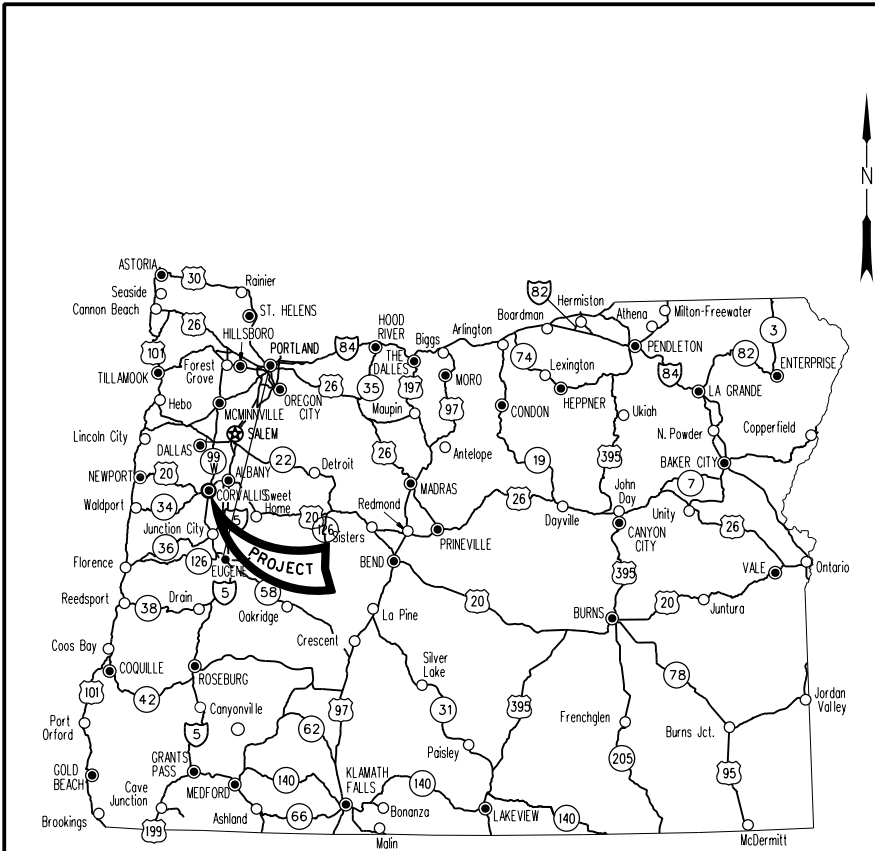

VICINITY MAP

SEC. 35, T.11S., R.5W., W.M.
LAT. 44°33'56", LONG. -123°15'23"

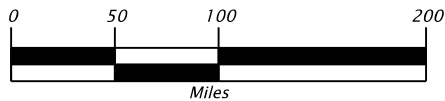

**Conceptual plans
utilized to obtain
Coast Guard
Bridge Permit**

DATE
12/12/22

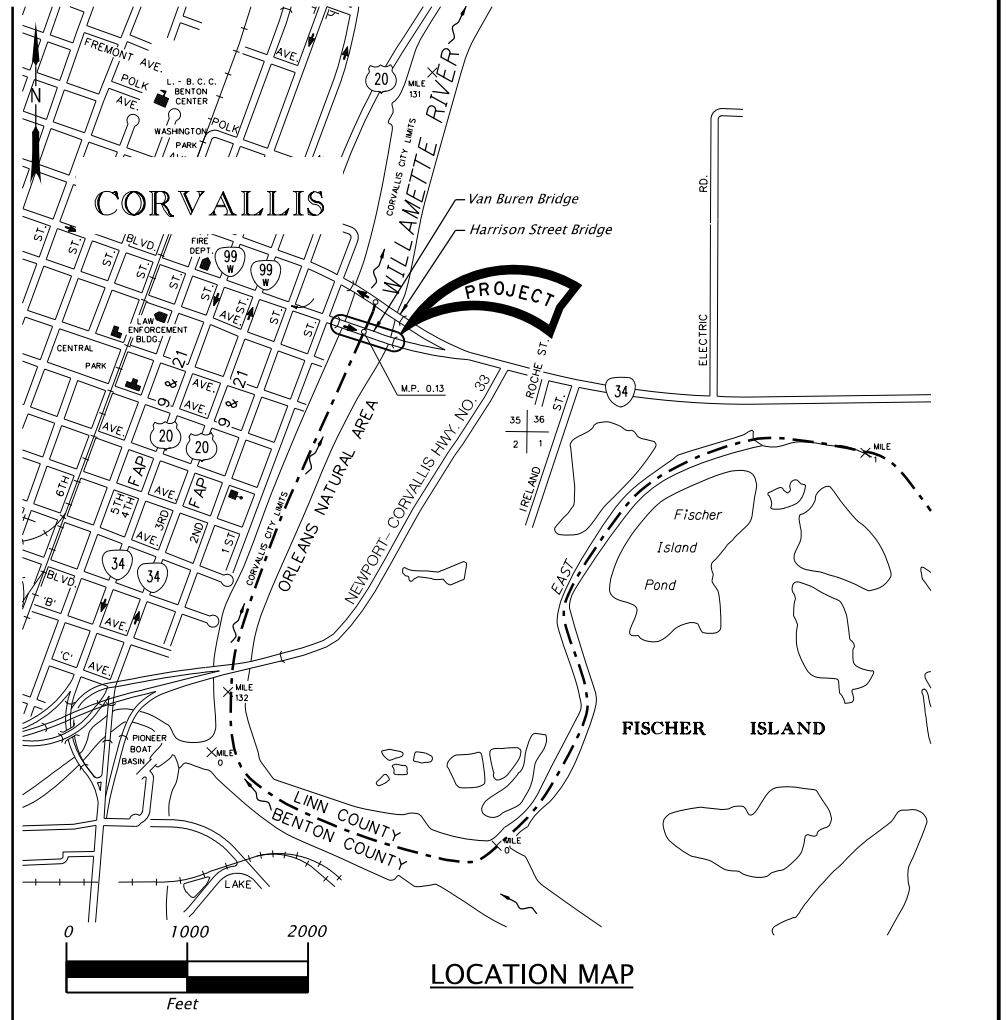

LOCATION MAP



EXPIRES: 6/30/.....

DOWL 

WWW.DOWL.COM

**VAN BUREN BRIDGE OVER THE
WILLAMETTE RIVER, RIVER MILE 132.1
BTW. CORVALLIS, BENTON COUNTY & LINN COUNTY, OR**
OWNER/APPLICANT: OREGON DEPARTMENT OF TRANSPORTATION

Designer: Andrew Howe, P.E. Reviewer: Jeff Parker, P.E.
Drafter: Jake Williams Checker: Jared Trowbridge, P.E.

VICINITY AND LOCATION MAPS

SHEET NO.
1 OF 3

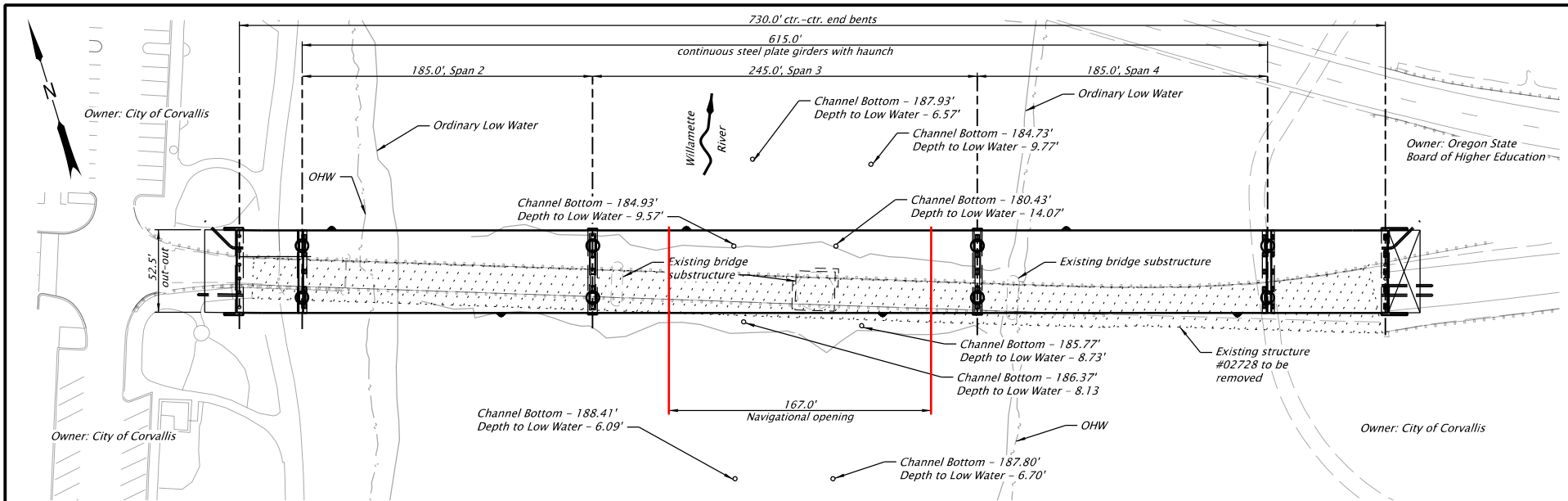

PLAN

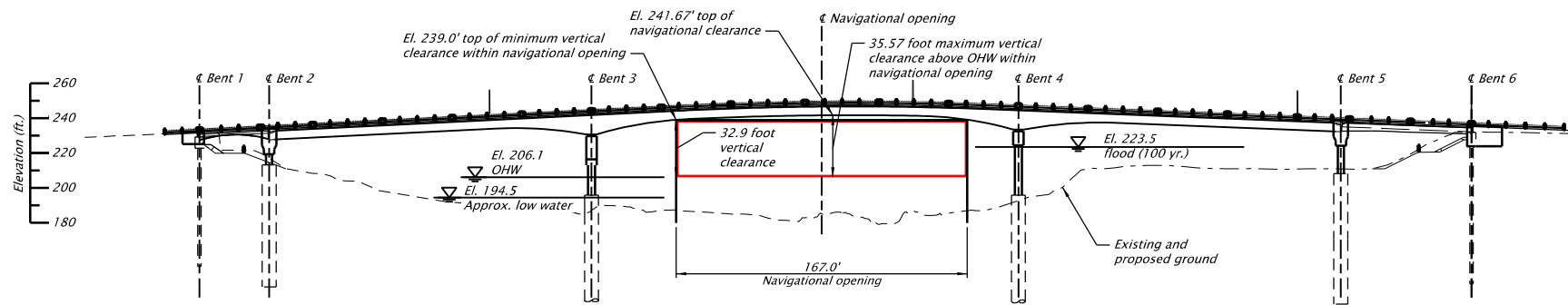

ELEVATION

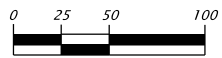

Total Permanent Removal (Existing Bridge, New Bridge, and Work Isolation Area): 2,864 CY
 Total Permanent Fill (New Bridge): 1,746 CY

**Conceptual plans
 utilized to obtain
 Coast Guard
 Bridge Permit**

Note:
 Elevations shown are based on North
 American Vertical Datum 1988 (NAVD88).

Note:
 Barrymetric data shown
 measured June 2019

DATE
 12/12/22

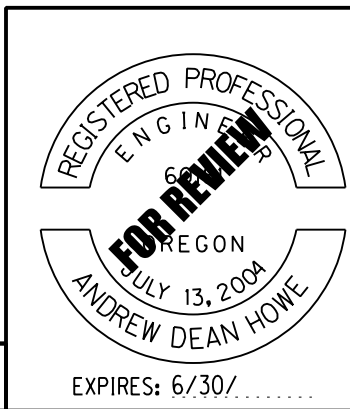

EXPIRES: 6/30/.....

DOWL WWW.DOWL.COM

**VAN BUREN BRIDGE OVER THE
 WILLAMETTE RIVER, RIVER MILE 132.1
 BTW. CORVALLIS, BENTON COUNTY & LINN COUNTY, OR
 OWNER/APPLICANT: OREGON DEPARTMENT OF TRANSPORTATION**

Designer: Andrew Howe, P.E. Reviewer: Jeff Parker, P.E.
 Drafter: Jake Williams Checker: Jared Trowbridge, P.E.

**PLAN AND ELEVATION
 FOR COAST GUARD PERMIT** SHEET NO.
 2 OF 3

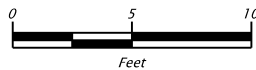
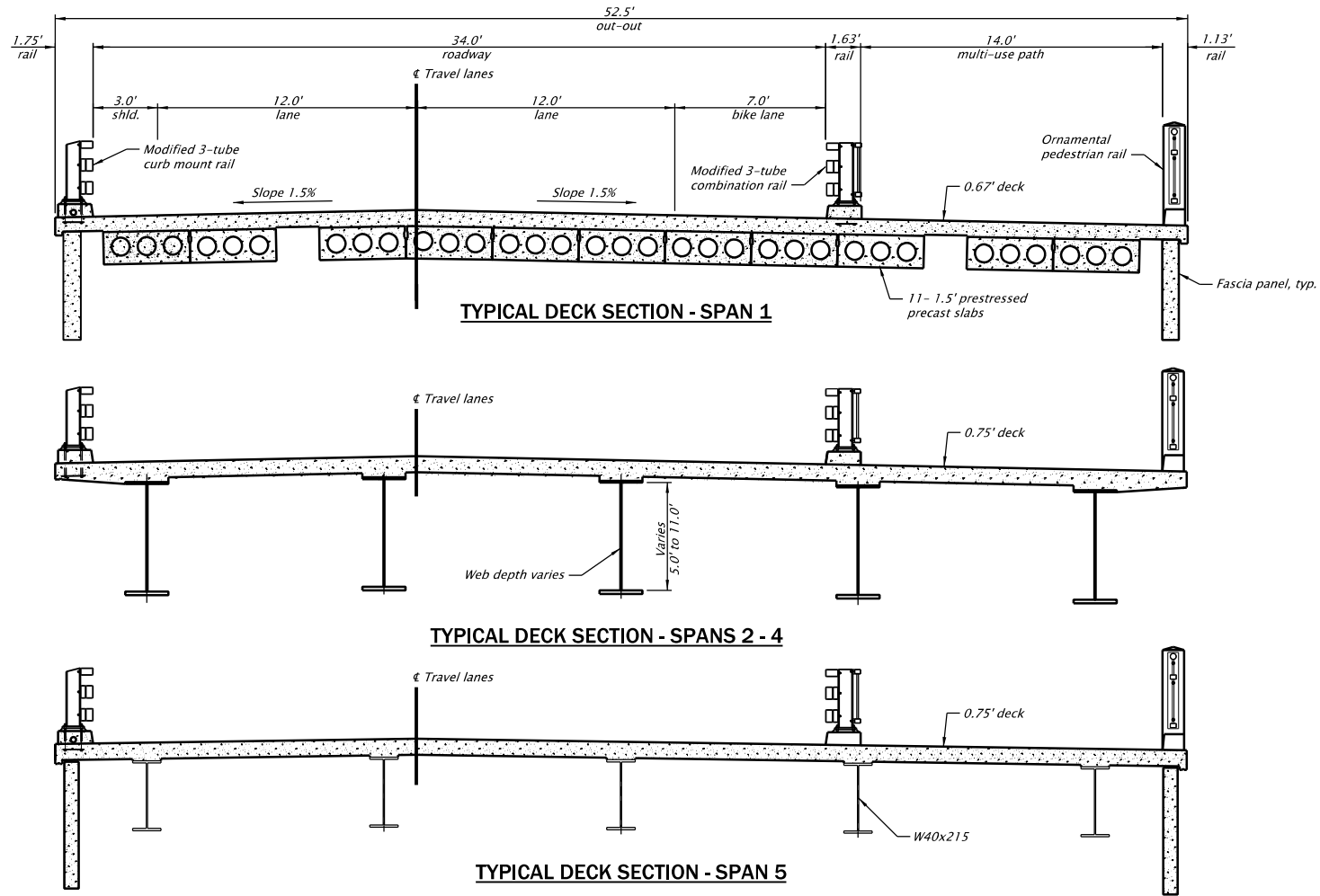

**Conceptual plans
utilized to obtain
Coast Guard
Bridge Permit**

DATE
12/12/22



EXPIRES: 6/30/.....



WWW.DOWL.COM



**VAN BUREN BRIDGE OVER THE
WILLAMETTE RIVER, RIVER MILE 132.1
BTW. CORVALLIS, BENTON COUNTY & LINN COUNTY, OR**
OWNER/APPLICANT: OREGON DEPARTMENT OF TRANSPORTATION

Designer: Andrew Howe, P.E.

Reviewer: Jeff Parker, P.E.

Drafter: Jake Williams

Checker: Jared Trowbridge, P.E.

TYPICAL DECK SECTIONS

SHEET NO.
3 of 3

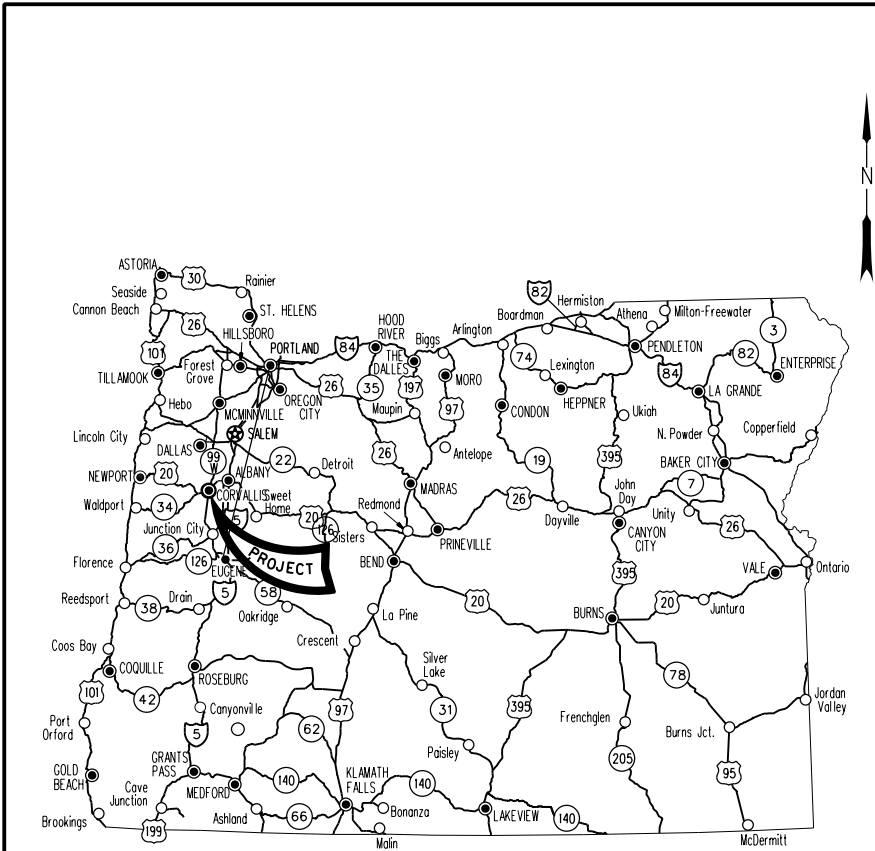

VICINITY MAP

SEC. 35, T.11S., R.5W., W.M.
LAT. 44°33'56", LONG. -123°15'23"

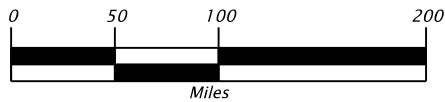

**Conceptual plans
utilized to obtain
Coast Guard
Bridge Permit**

DATE
12/12/22

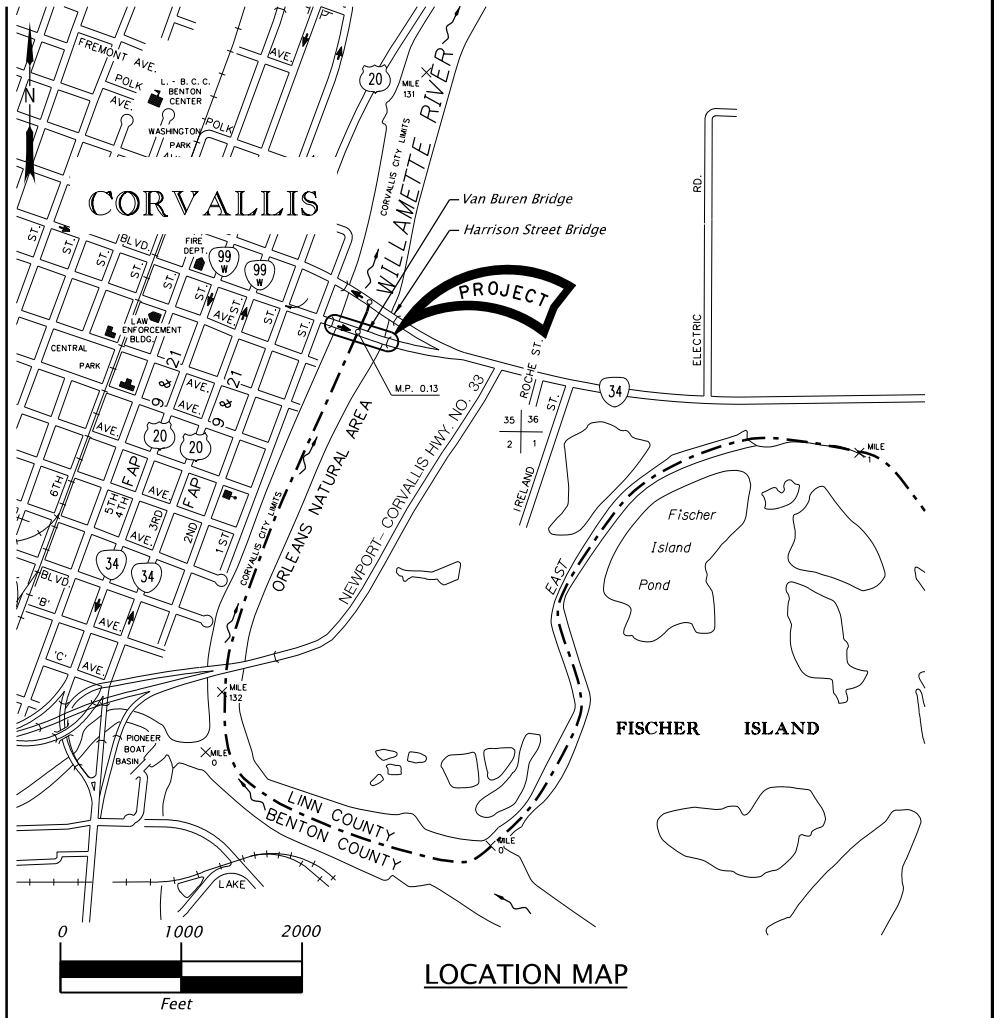

LOCATION MAP



EXPIRES: 6/30/.....

DOWL
WWW.DOWL.COM

**VAN BUREN BRIDGE OVER THE
WILLAMETTE RIVER, RIVER MILE 132.1
BTW. CORVALLIS, BENTON COUNTY & LINN COUNTY, OR**
OWNER/APPLICANT: OREGON DEPARTMENT OF TRANSPORTATION

Designer: Andrew Howe, P.E. Reviewer: Jeff Parker, P.E.
Drafter: Jake Williams Checker: Jared Trowbridge, P.E.

VICINITY AND LOCATION MAPS SHEET NO.
1 OF 5

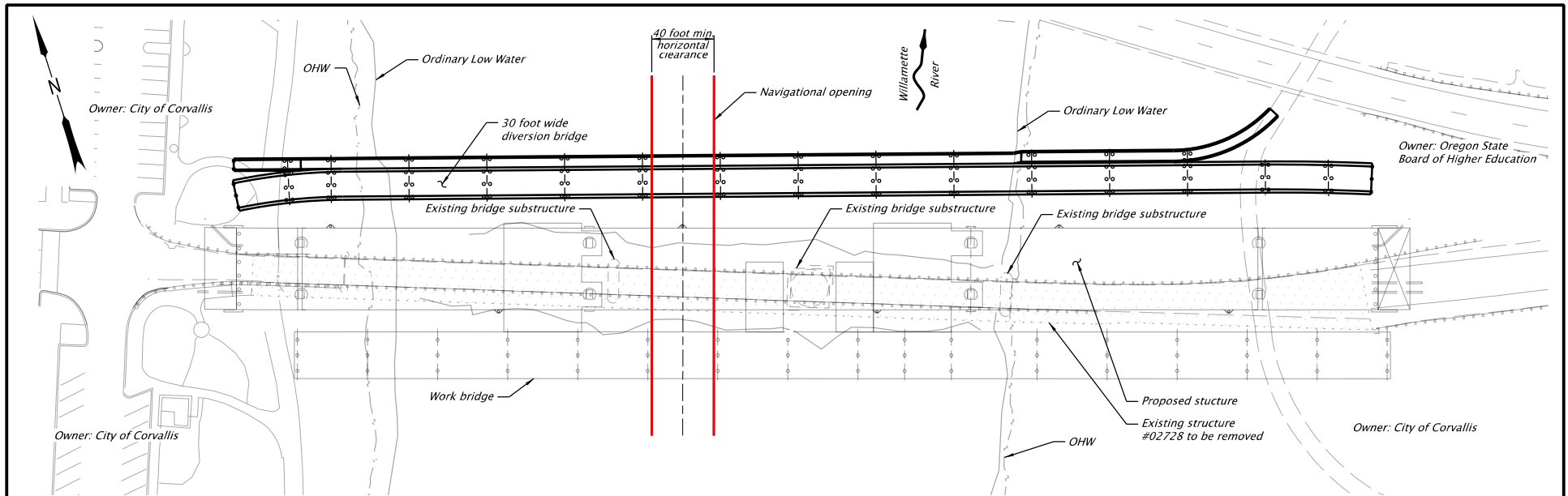

PLAN - TEMPORARY DIVERSION BRIDGE

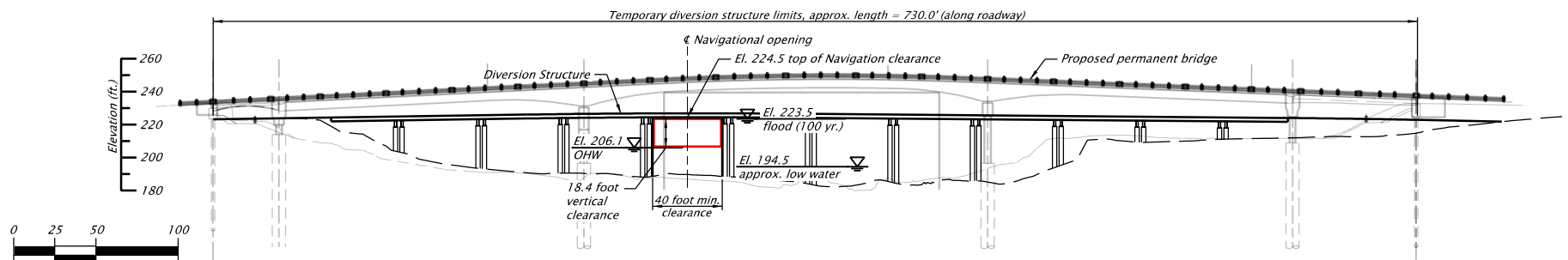

ELEVATION - TEMPORARY DIVERSION BRIDGE

Up to 799 CY of fill and 799 CY of removal associated with detour bridge piles

Total Permanent Removal (Detour and Work Bridges): 2,860 CY
 Total Permanent Fill (Detour and Work Bridges): 2,860 CY

Other Temporary Removal: 54 CY
 Other Temporary Fill: 54 CY

**Conceptual plans
 utilized to obtain
 Coast Guard
 Bridge Permit**

Note:
 Elevations shown are based on North
 American Vertical Datum 1988 (NAVD88).

DATE
 12/12/22



EXPIRES: 6/30/.....



WWW.DOWL.COM



**VAN BUREN BRIDGE OVER THE
 WILLAMETTE RIVER, RIVER MILE 132.1
 BTW. CORVALLIS, BENTON COUNTY & LINN COUNTY, OR
 OWNER/APPLICANT: OREGON DEPARTMENT OF TRANSPORTATION**

Designer: Andrew Howe, P.E.

Reviewer: Jeff Parker, P.E.

Drafter: Jake Williams

Checker: Jared Trowbridge, P.E.

**TEMP. DIVERSION BRIDGE PLAN AND
 ELEVATION FOR COAST GUARD PERMIT**

SHEET NO.
 2 OF 5

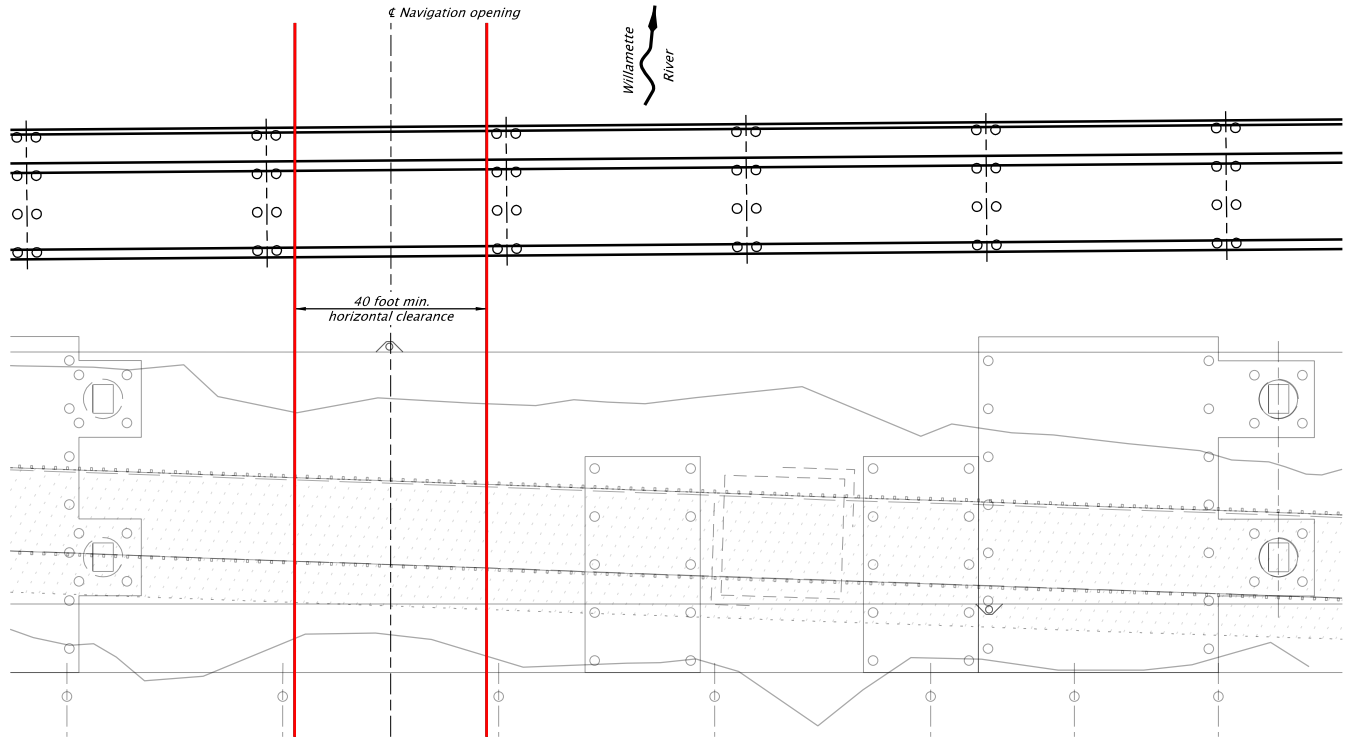

PLAN - DIVERSION BRIDGE

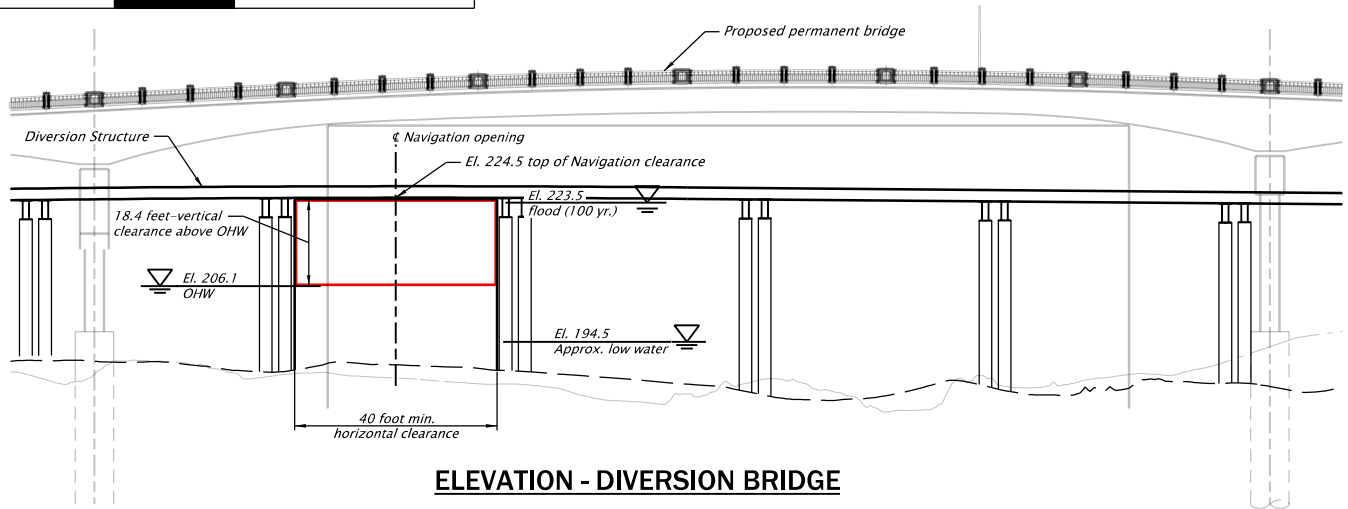
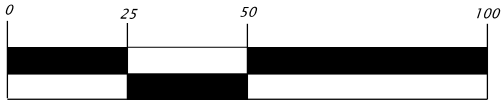

ELEVATION - DIVERSION BRIDGE

**Conceptual plans
utilized to obtain
Coast Guard
Bridge Permit**

Note:
Elevations shown are based on North
American Vertical Datum 1988 (NAVD88).

DATE
12/12/22



EXPIRES: 6/30/.....



**VAN BUREN BRIDGE OVER THE
WILLAMETTE RIVER, RIVER MILE 132.1
BTW. CORVALLIS, BENTON COUNTY & LINN COUNTY, OR
OWNER/APPLICANT: OREGON DEPARTMENT OF TRANSPORTATION**

Designer: Andrew Howe, P.E.

Reviewer: Jeff Parker, P.E.

Drafter: Jake Williams

Checker: Jared Trowbridge, P.E.

**DIVERSION BRIDGE NAVIGATION DETAIL
FOR COAST GUARD PERMIT**

SHEET NO.
3 OF 5

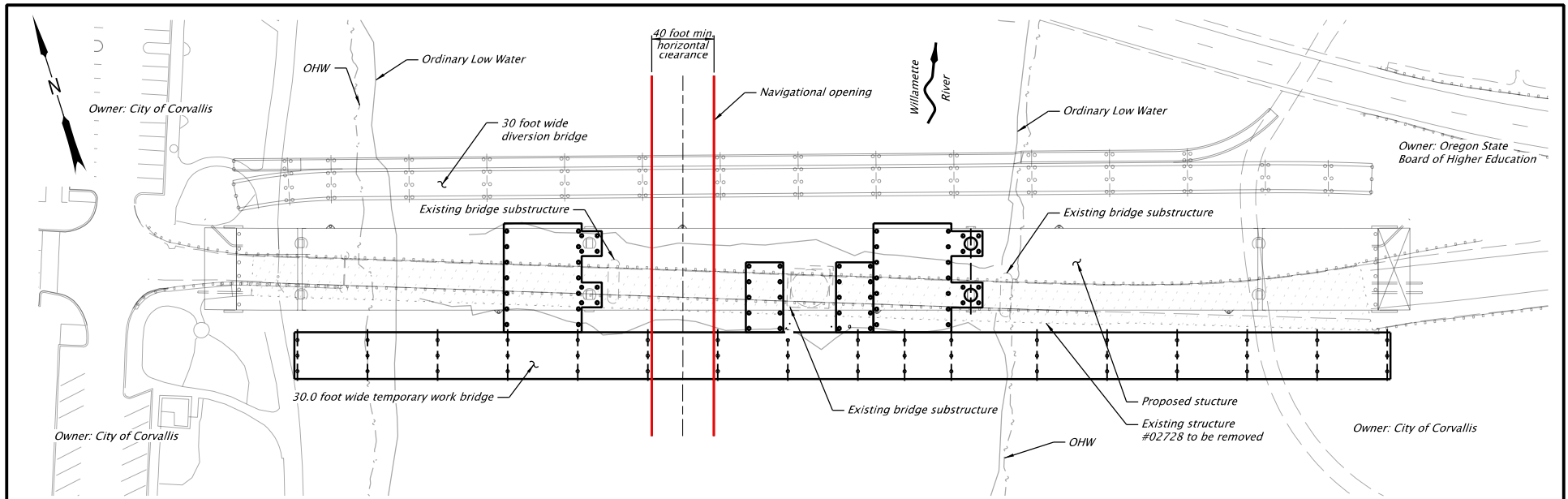

PLAN - TEMPORARY WORK BRIDGE

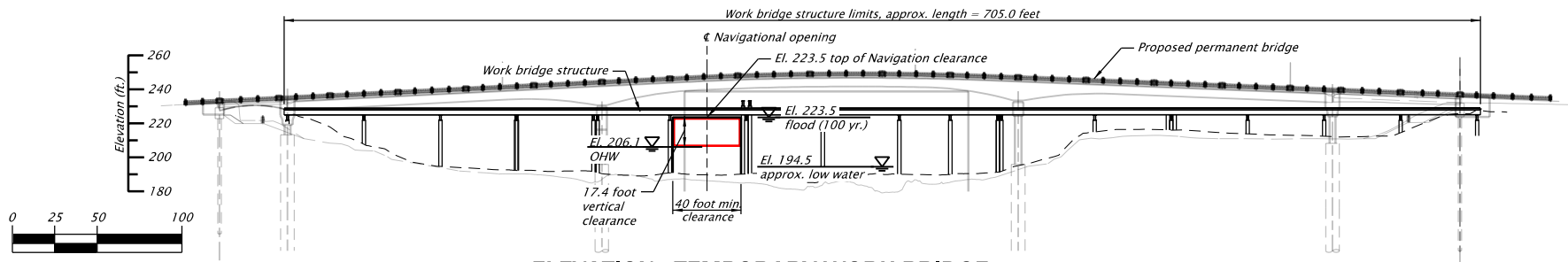

ELEVATION - TEMPORARY WORK BRIDGE

Up to 799 CY of fill and 799 CY of removal associated with detour bridge piles

Total Permanent Removal (Detour and Work Bridges): 2,860 CY
 Total Permanent Fill (Detour and Work Bridges): 2,860 CY

Other Temporary Removal: 54 CY
 Other Temporary Fill: 54 CY

**Conceptual plans
 utilized to obtain
 Coast Guard
 Bridge Permit**

Note:
 Elevations shown are based on North
 American Vertical Datum 1988 (NAVD88).

DATE
 12/12/22



EXPIRES: 6/30/.....



WWW.DOWL.COM



**VAN BUREN BRIDGE OVER THE
 WILLAMETTE RIVER, RIVER MILE 132.1
 BTW. CORVALLIS, BENTON COUNTY & LINN COUNTY, OR
 OWNER/APPLICANT: OREGON DEPARTMENT OF TRANSPORTATION**

Designer: Andrew Howe, P.E.

Reviewer: Jeff Parker, P.E.

Drafter: Jake Williams

Checker: Jared Trowbridge, P.E.

**TEMP. WORK BRIDGE PLAN AND
 ELEVATION FOR COAST GUARD PERMIT**

SHEET NO.
 4 OF 5

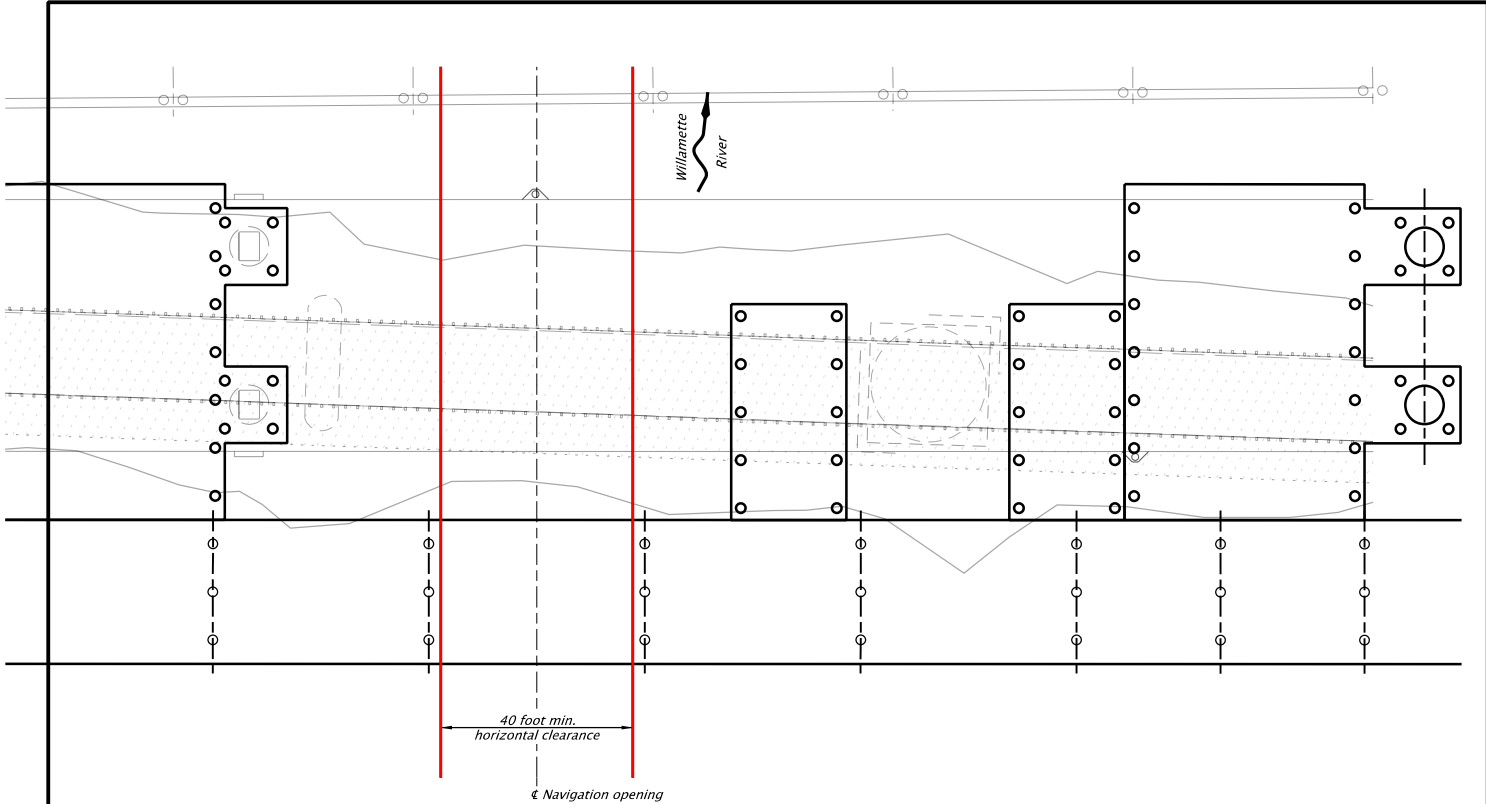

PLAN - TEMPORARY WORK BRIDGE

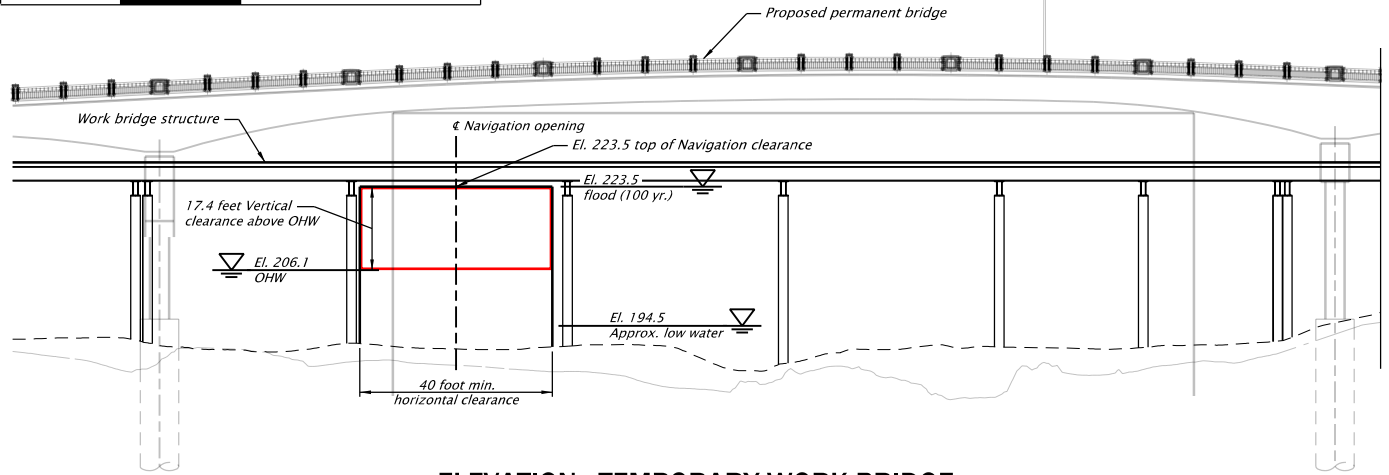
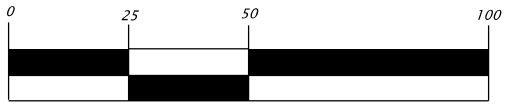

ELEVATION - TEMPORARY WORK BRIDGE

Sheet 8 Work Navigation Detail.dgn :: Plan and Elevation 12/12/2022 8:14:28 AM JWilliams

**Conceptual plans
utilized to obtain
Coast Guard
Bridge Permit**

Note:
Elevations shown are based on North
American Vertical Datum 1988 (NAVD88)

DATE
12/12/22



EXPIRES: 6/30/.....

DOWL WWW.DOWL.COM

OREGON DEPARTMENT OF TRANSPORTATION

**VAN BUREN BRIDGE OVER THE
WILLAMETTE RIVER, RIVER MILE 132.1
BTW. CORVALLIS, BENTON COUNTY & LINN COUNTY, OR
OWNER/APPLICANT: OREGON DEPARTMENT OF TRANSPORTATION**

Designer: Andrew Howe, P.E. Reviewer: Jeff Parker, P.E.
Drafter: Jake Williams Checker: Jared Trowbridge, P.E.

**WORK BRIDGE NAVIGATION DETAIL
FOR COAST GUARD PERMIT** SHEET NO. 5 OF 5